

APPENDIX D
AIRPORT LAYOUT PLAN

Date Plotted: 7/17/2008, 3:57 PM
 Layout Name: P:\Projects\088337\ALP\ALP-SEWARD-DATA.dwg
 File Name:
 Designed By: jones
 Drawn By: mbauer
 Checked By: branson

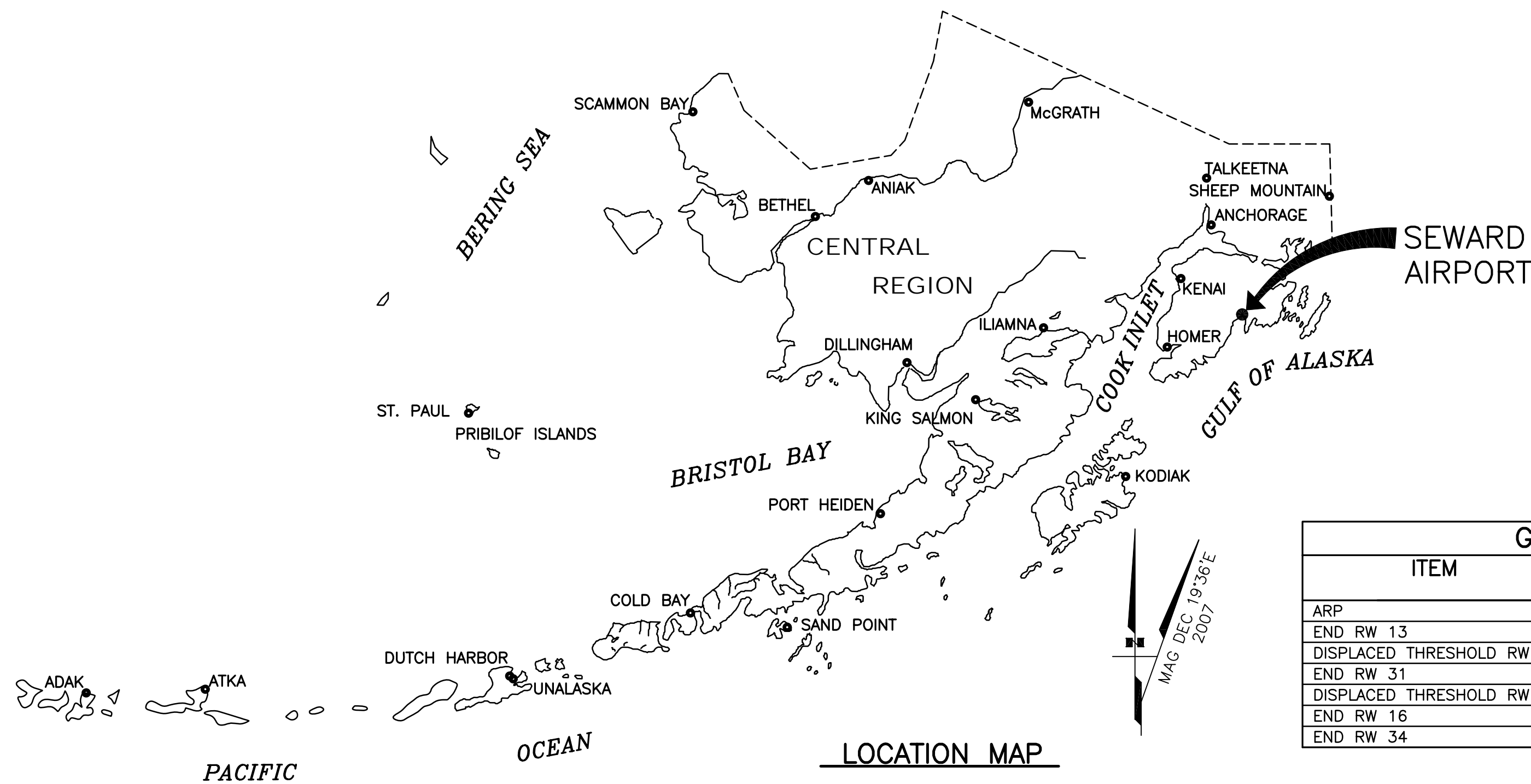

LEGEND		
ITEM	EXISTING	ULTIMATE
AIRPORT REFERENCE POINT (A.R.P.)		
ANTENNA		
BLUFF		
BUILDINGS		
BUILDING RESTRICTION LINE		
FENCE		
PAPI		
PROPERTY LINE		
REIL		
ROADWAYS		
ROTATING BEACON		
SHORELINE		
SURVEY MONUMENT		
THRESHOLD MARKERS/LIGHTS		
TOPOGRAPHIC CONTOURS		
TREE (LARGE SINGLE)		
TREELINE		
VASI		
WIND CONE		
WIND CONE AND SEGMENTED CIRCLE		
LIGHT		
POWER POLE		

GEOGRAPHIC COORDINATES TABLE				
ITEM	EXISTING LATITUDE	EXISTING LONGITUDE	ULTIMATE LATITUDE	ULTIMATE LONGITUDE
ARP	60°07'47.59"N	149°24'59.87"W	60°07'48.29"N	149°25'00.64"W
END RW 13	60°08'03.75"N	149°25'15.61"W	60°08'06.05"N	149°25'18.79"W
DISPLACED THRESHOLD RW 13	---	---	60°08'03.72"N	149°25'15.69"W
END RW 31	60°07'28.89"N	149°24'29.19"W	60°07'28.87"N	149°24'29.27"W
DISPLACED THRESHOLD RW 31	---	---	60°07'29.69"N	149°24'30.36"W
END RW 16	60°08'01.20"N	149°25'15.07"W	60°08'01.20"N	149°25'15.07"W
END RW 34	60°07'38.69"N	149°25'12.38"W	60°07'38.69"N	149°25'12.38"W

RUNWAY 13/31 DATA TABLE			
ITEM	EXISTING	NEAR-TERM	ULTIMATE
RUNWAY TYPE	ENTER UTILITY OR >UTILITY	OTHER THAN UTILITY	OTHER THAN UTILITY
FAR PART 77 APPROACH CATEGORY (V, NPI, P)	V / V		V / V
APPROACH SURFACES	20:1 / 20:1		20:1 / 20:1
VISIBILITY MINIMUM	≥ 1SM / ≥ 1SM		≥ 1SM / ≥ 1SM
RUNWAY SURFACE	ASPHALT		ASPHALT
PAVEMENT STRENGTH SW,DW,DTW,DDTW 1000lbs	---		---
AIRCRAFT APPROACH CATEGORY	B		B
AIRPLANE DESIGN GROUP	II		II
RUNWAY DIMENSIONS	100' X 4249'		100' X 4533'
TRUE BEARING	N 33° 36' 3.6" W		N 33° 36' 3.6" W
EFFECTIVE GRADE	0.2 %		0.2 %
TOUCHDOWN ELEVATION (MSL NAVD88)	27.7' / 19.5'		29.1' / 19.5'
RUNWAY SAFETY AREA (RSA)	150' X 4749'		150' X 4749'
LENGTH BEYOND R/W END	300' / 200'		16' / 200'
RUNWAY PROTECTION ZONE (RPZ)	500' X 700' X 1000'		500' X 700' X 1000'
RUNWAY OBJECT FREE AREA (OFA)	500' X 4749'		500' X 4749'
LENGTH BEYOND R/W END	300' / 200'		16' / 200'
RUNWAY OBSTACLE FREE ZONE (OFZ)	400' X 4649'		400' X 4933'
RUNWAY LIGHTING	M.I.		M.I.
RUNWAY MARKING TYPE	VISUAL		VISUAL
RUNWAY VISUAL APPROACH AIDS	VASI (31 END ONLY)		PAPI, REIL

RUNWAY 16/34 DATA TABLE			
ITEM	EXISTING	NEAR-TERM	ULTIMATE
RUNWAY TYPE	ENTER UTILITY OR >UTILITY	UTILITY	UTILITY
FAR PART 77 APPROACH CATEGORY (V, NPI, P)	V / V		V / V
APPROACH SURFACES	20:1 / 20:1		20:1 / 20:1
VISIBILITY MINIMUM	≥ 1SM / ≥ 1SM		≥ 1SM / ≥ 1SM
RUNWAY SURFACE	ASPHALT		ASPHALT
PAVEMENT STRENGTH SW,DW,DTW,DDTW 1000lbs	---		---
AIRCRAFT APPROACH CATEGORY	A		A
AIRPLANE DESIGN GROUP	I		I
RUNWAY DIMENSIONS	75' X 2289'		75' X 2289'
TRUE BEARING	N 3° 24' 30.6" W		N 3° 24' 30.6" W
EFFECTIVE GRADE	0.3 %		0.3 %
TOUCHDOWN ELEVATION (MSL NAVD88)	25.5' / 25.5'		25.5' / 25.5'
RUNWAY SAFETY AREA (RSA)	120' X 2769'		120' X 2769'
LENGTH BEYOND R/W END	240' / 240'		240' / 240'
RUNWAY PROTECTION ZONE (RPZ)	250' X 450' X 1000'		250' X 450' X 1000'
RUNWAY OBJECT FREE AREA (OFA)	250' X 2769'		250' X 2769'
LENGTH BEYOND R/W END	240' / 240'		240' / 240'
RUNWAY OBSTACLE FREE ZONE (OFZ)	120' X 2689'		120' X 2689'
RUNWAY LIGHTING	NONE		M.I.
RUNWAY MARKING TYPE	VISUAL		VISUAL
RUNWAY VISUAL APPROACH AIDS	NONE		PAPI, REIL

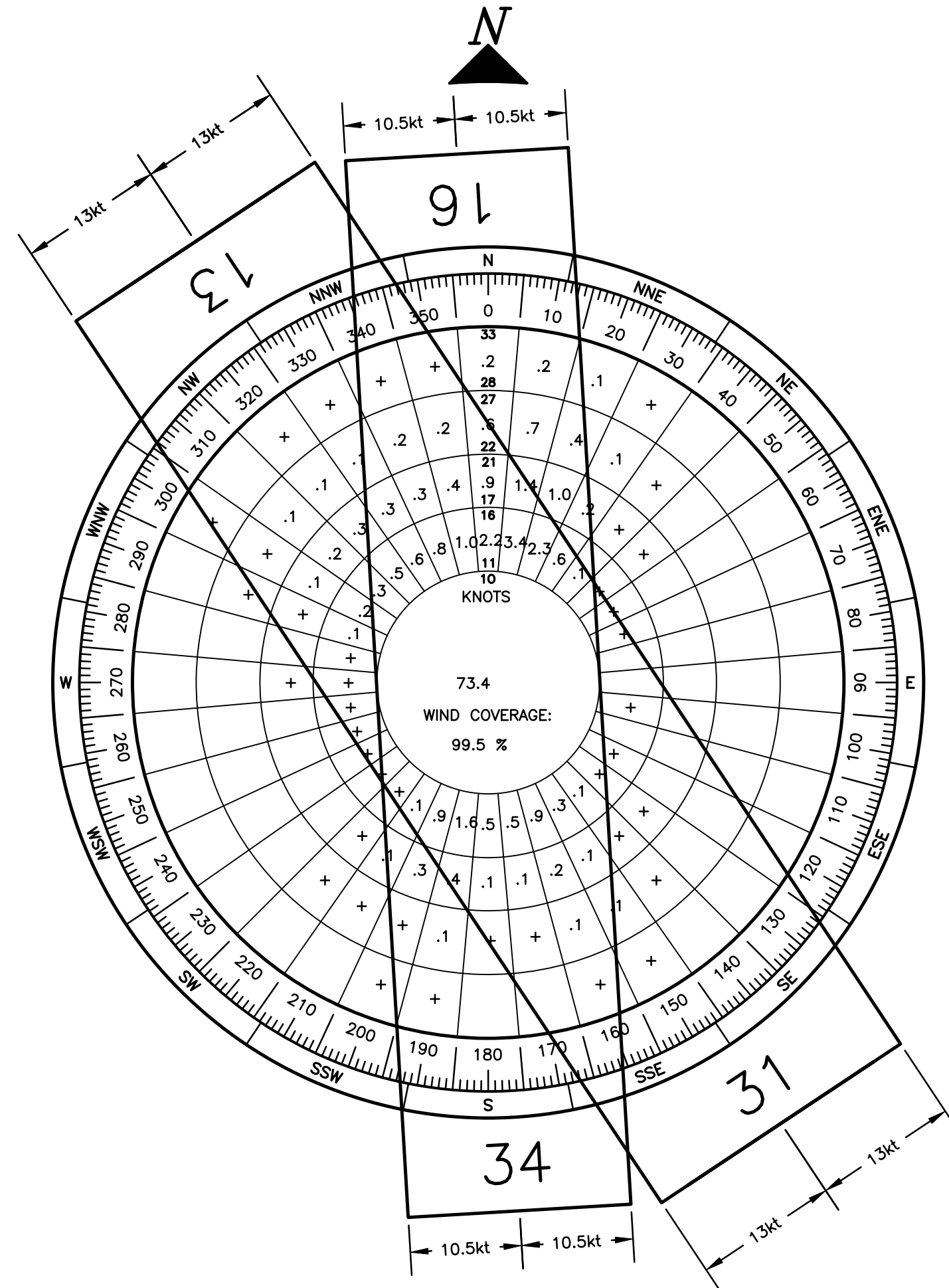

WIND DATA TABLE				
RUNWAY	10.5 kt	13 kt	16 kt	20 kt
13/31	89.3%	94.8%	---	---
16/34	98.3%	99.3%	---	---
COMBINED	99.5%	99.9%	---	---

SOURCE: U.S. DEPARTMENT OF COMMERCE, NATIONAL OCEANIC AND ATMOSPHERIC ADMINISTRATION, WESTERN REGION CLIMATE CENTER, DECEMBER, 2003

PERIOD: 01/1998-12/2003

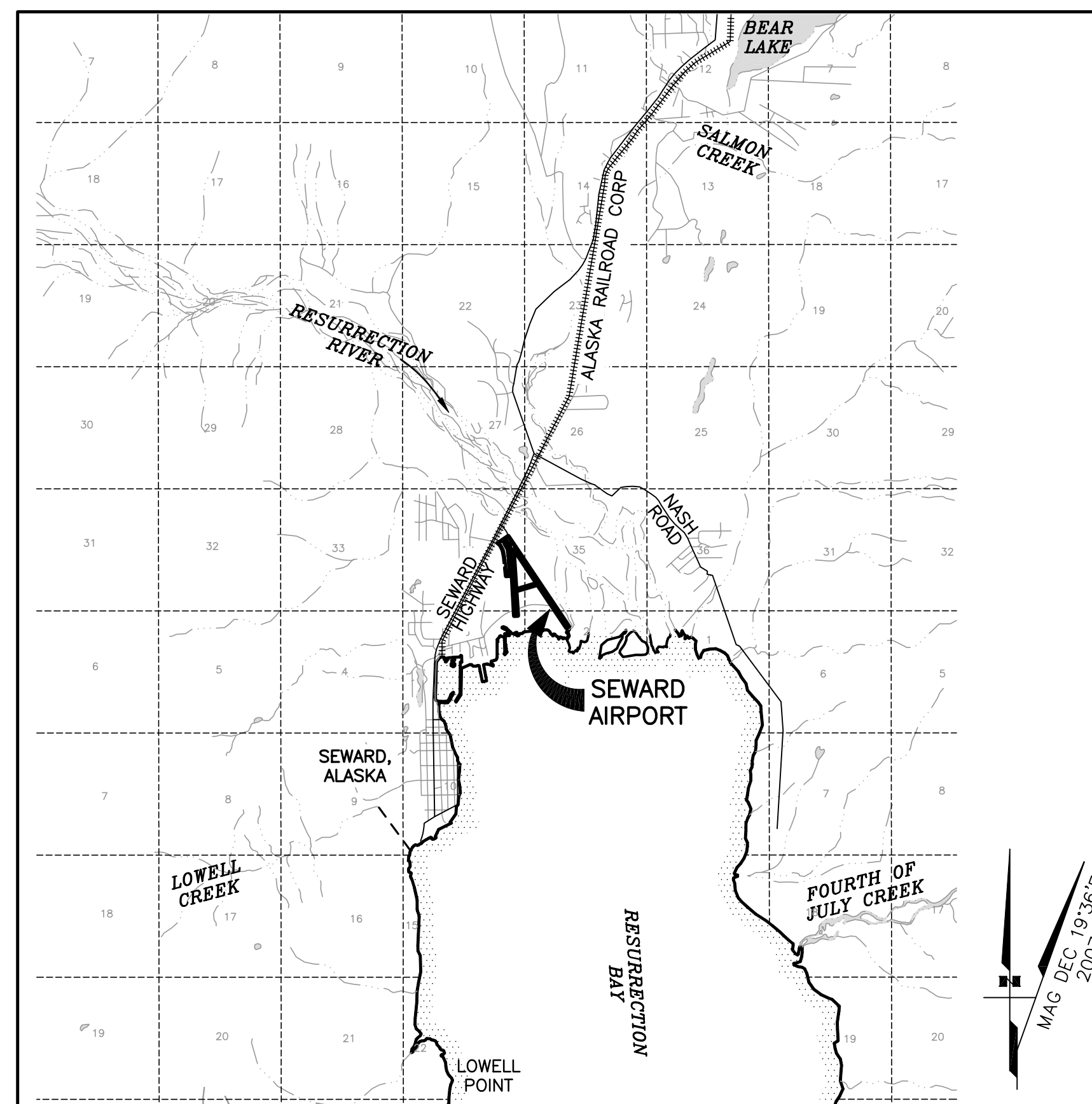

VICINITY MAP
 T1N, R1W, SEC. 34 & 35
 T1S, R1W, SEC. 2 & 3
 SEWARD MERIDIAN
 U.S.G.S. SEWARD (A-7), ALASKA

MODIFICATION TO STANDARDS/ NON STANDARD CONDITIONS			
DESCRIPTION	STANDARD	EXISTING	ULTIMATE
RSA LENGTH BEYOND END OF RUNWAY 13*	300'	16'	16'
RSA LENGTH BEYOND END OF RUNWAY 31*	300'	200'	200'

*ADDRESSED BY IMPLEMENTATION OF DECLARED DISTANCES IN ULTIMATE PLAN.

AIRPORT DATA TABLE		
ITEM	EXISTING	ULTIMATE
ICAO IDENTIFIER	PAWD	PAWD
NATIONAL AIRPORT IDENTIFIER	SWD	SWD
FAA SITE NUMBER	50696.*A	50696.*A
AIRPORT ELEVATION (MSL NAVD88)	27.7'	29.1'
AIRPORT REFERENCE CODE	B II	B II
MEAN MAX. TEMPERATURE, HOTTEST MONTH	62.3 F JULY	62.3 F JULY
AIRPORT AND TERMINAL NAVIGATION AIDS	ROTATING BEACON	ROTATING BEACON
TAXIWAY LIGHTING/MARKING	M.I. / NA	M. I. / NA
OBSTRUCTION SURVEY SOURCE & TYPE	NONE	NONE
MAGNETIC DECLINATION, YEAR, RATE OF CHANGE	19°36'E, 2007,	0°16' W / YEAR

DRAWING INDEX	
SHT #	TITLE
1	AIRPORT DATA SHEET
2	EXISTING AIRPORT LAYOUT PLAN
3	ULTIMATE AIRPORT LAYOUT PLAN
4	DECLARED DISTANCES
5	INNER PORTION OF THE APPROACH SURFACE-R/W 13/31
6	INNER PORTION OF THE APPROACH SURFACE-R/W 16/34
7	AIRPORT AIRSPACE 14 CFR, PART 77
8	TERMINAL AREA
9	PROPERTY MAP

BY DATE	REVISION
APPROVED: _____	DATE: _____
ROBERT A. CAMPBELL, P.E. PRECONSTRUCTION ENGINEER	DATE: _____
RECOMMENDED: _____	DATE: _____
HARVEY M. DOUTHIT, P.E. DESIGN SECTION CHIEF	DATE: _____

STATE OF ALASKA DEPARTMENT OF TRANSPORTATION AND PUBLIC FACILITIES CENTRAL REGION	
SEWARD AIRPORT SEWARD, ALASKA AIRPORT LAYOUT PLAN	AIRPORT DATA SHEET
DATE: 07/17/2008	SHEET: 1 OF 9

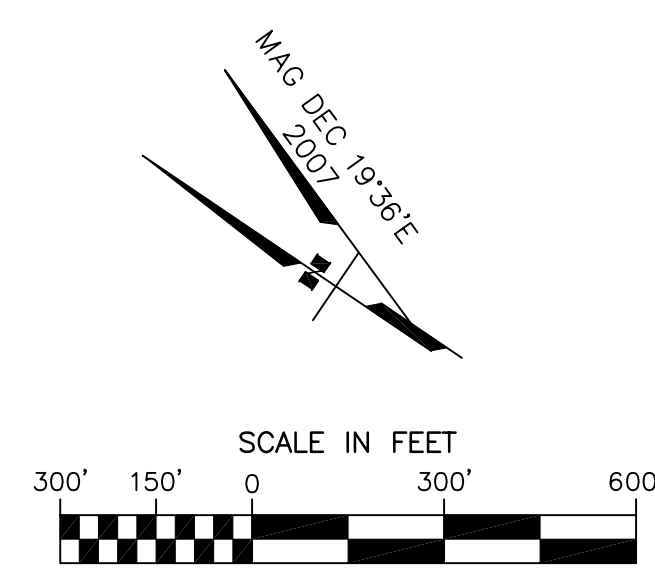
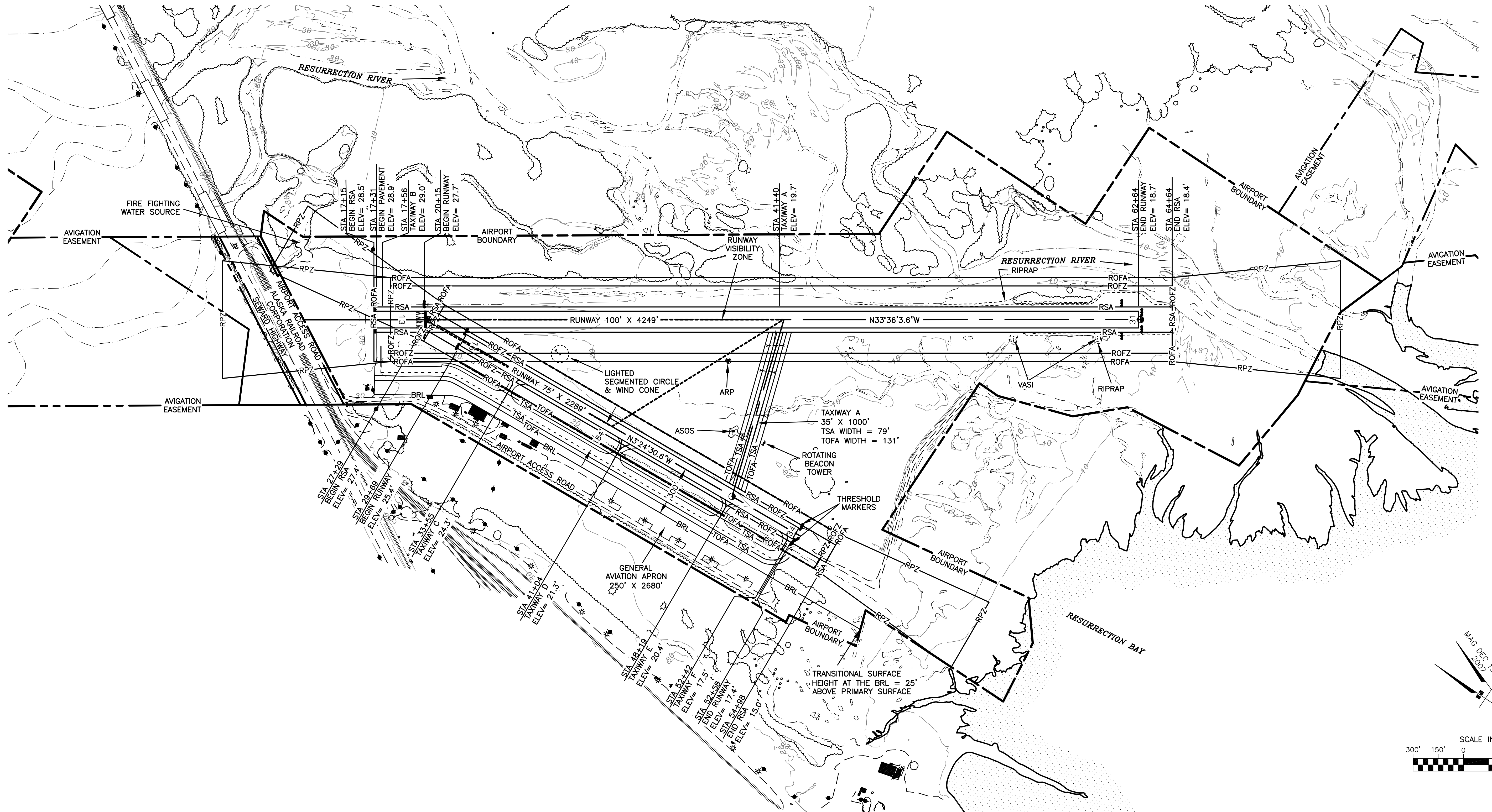

NOTE:

- 1. NO ROFZ OBJECT PENETRATIONS.
- 2. RUNWAY ELEVATIONS INTERPOLATED FROM SURVEYED POINTS ALONG RUNWAY CENTERLINES.

BY	DATE
REVISION	
SEWARD AIRPORT SEWARD, ALASKA AIRPORT LAYOUT PLAN EXISTING AIRPORT LAYOUT PLAN	
DATE:	07/17/2008
SHEET:	2
OF	9

7/17/2008, 4:14 PM
LAYOUT (3)
P:\Projects\080337\ALPALP-SEWARD.dwg
Designed By: j.jones
Drawn By: mbauer
Checked By: branson

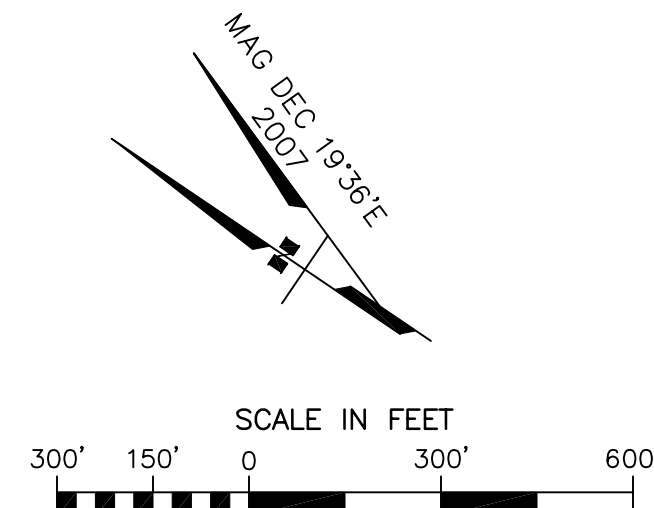
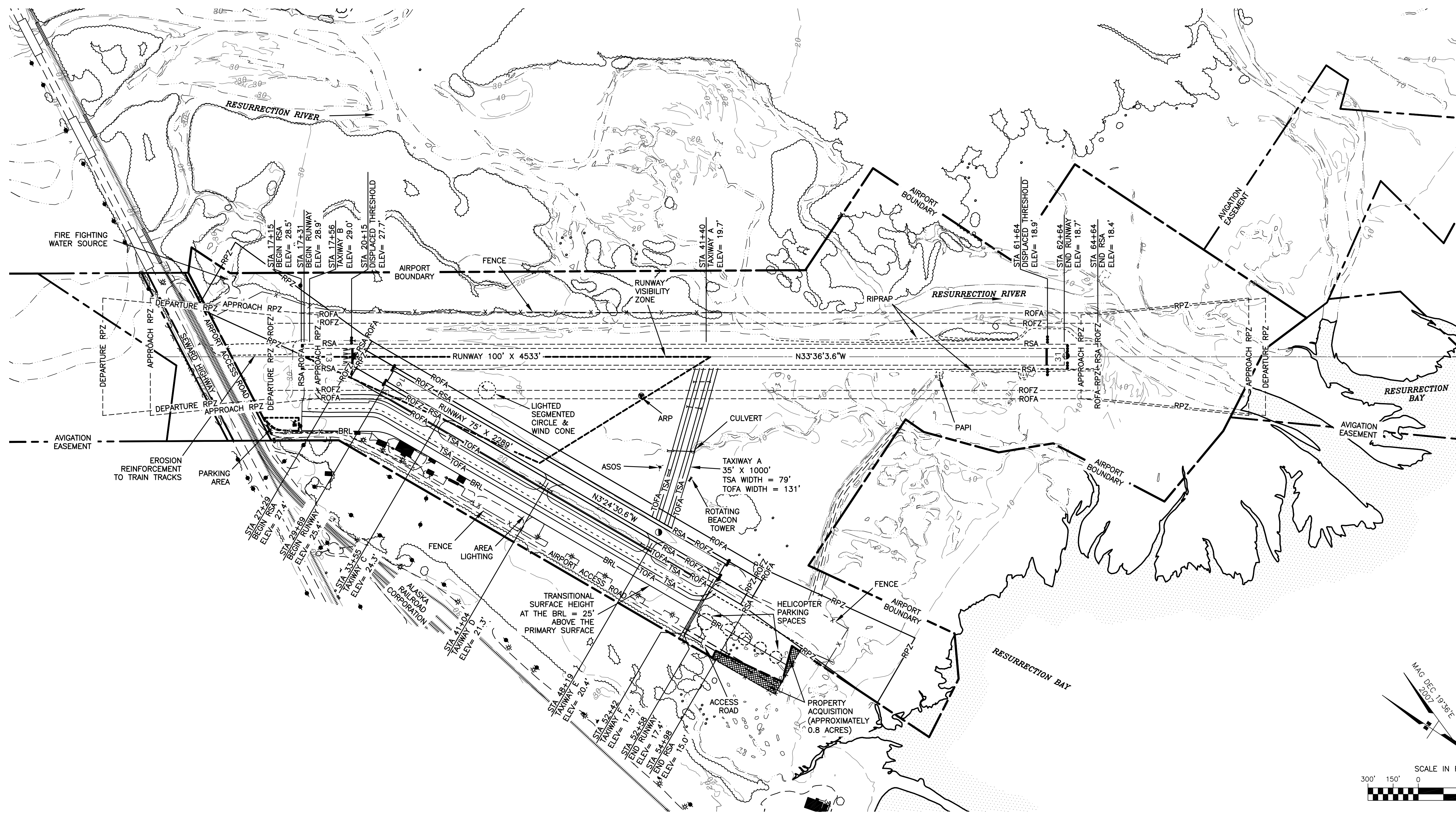

NOTES:

- 1. NO ROFZ OBJECT PENETRATIONS.
- 2. ULTIMATE RUNWAY 13-31 IS SHIFTED 6' TOWARD THE APRON AND RAISED SLIGHTLY.
- 3. RUNWAY ELEVATIONS INTERPOLATED FROM SURVEY POINTS ALONG RUNWAY CENTERLINES.

BY	DATE	REVISION

SEWARD AIRPORT
SEWARD, ALASKA
AIRPORT LAYOUT PLAN
ULTIMATE AIRPORT LAYOUT PLAN

DATE: 07/17/2008
SHEET: 3 OF 9

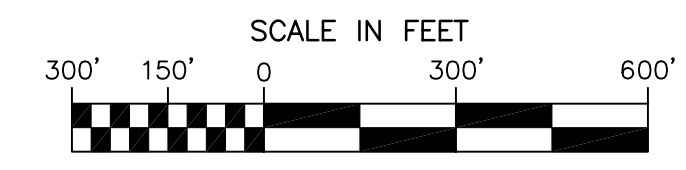
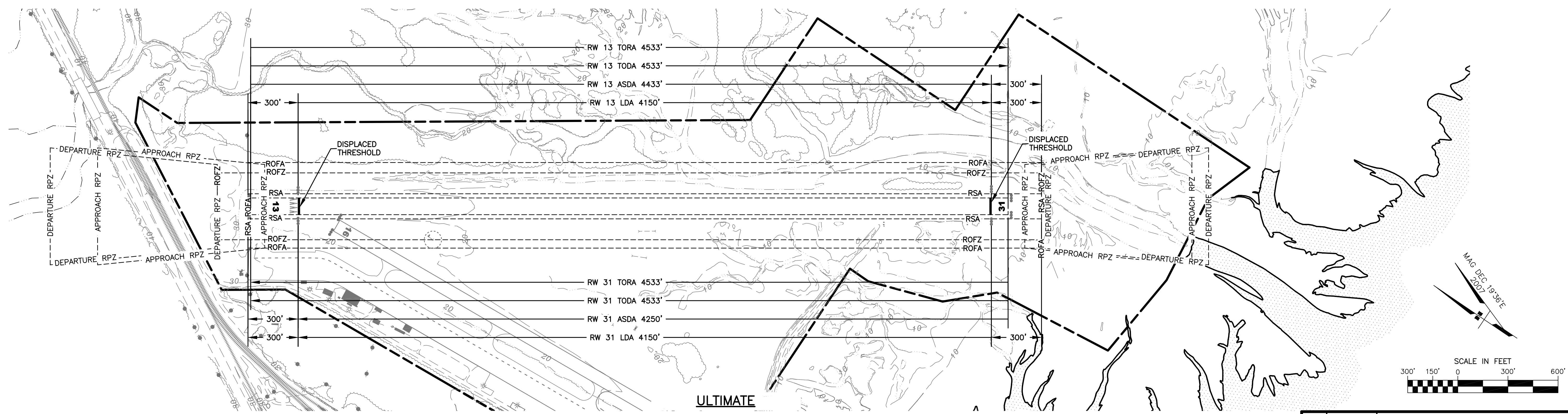
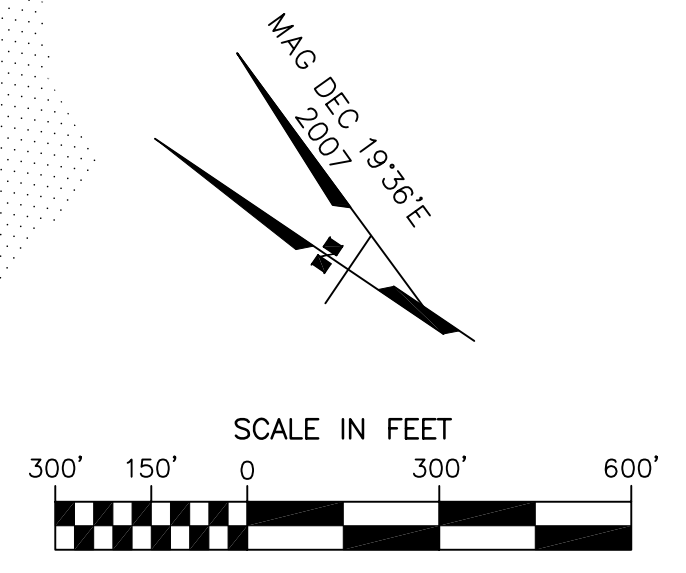
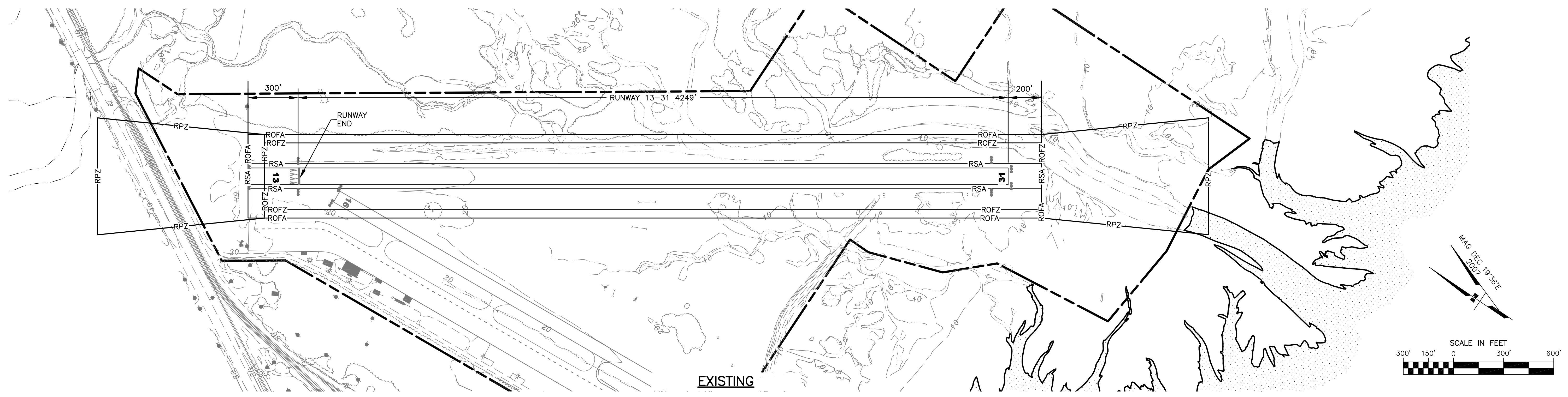

DECLARED DISTANCES				
ITEM	RUNWAY 13/31		RUNWAY 16/34	
	EXISTING	FUTURE	EXISTING	FUTURE
TAKEOFF RUN AVAILABLE	N / A	4,533 / 4,533	N / A	N / A
TAKEOFF DISTANCE AVAILABLE	N / A	4,533 / 4,533	N / A	N / A
ACCELERATE STOP DISTANCE AVAILABLE	N / A	4,433 / 4,250	N / A	N / A
LANDING DISTANCE AVAILABLE	N / A	4,150 / 4,150	N / A	N / A

BY	DATE	REVISION
SEWARD AIRPORT SEWARD, ALASKA AIRPORT LAYOUT PLAN		DATE: 07/17/2008
DECLARED DISTANCES		SHEET: 4 OF 9

DOWL FILE No.: 232-104-5

Designed By: j.jones
 Drawn By: mbauer
 Checked By: branson

Date Plotted: 7/18/2008, 8:27 AM
 Layout Name: APR13-31 (5)
 File Name: P:\Projects\088337\ALP\ALP-SEWARD.dwg

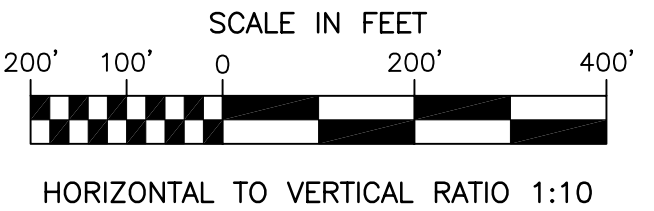
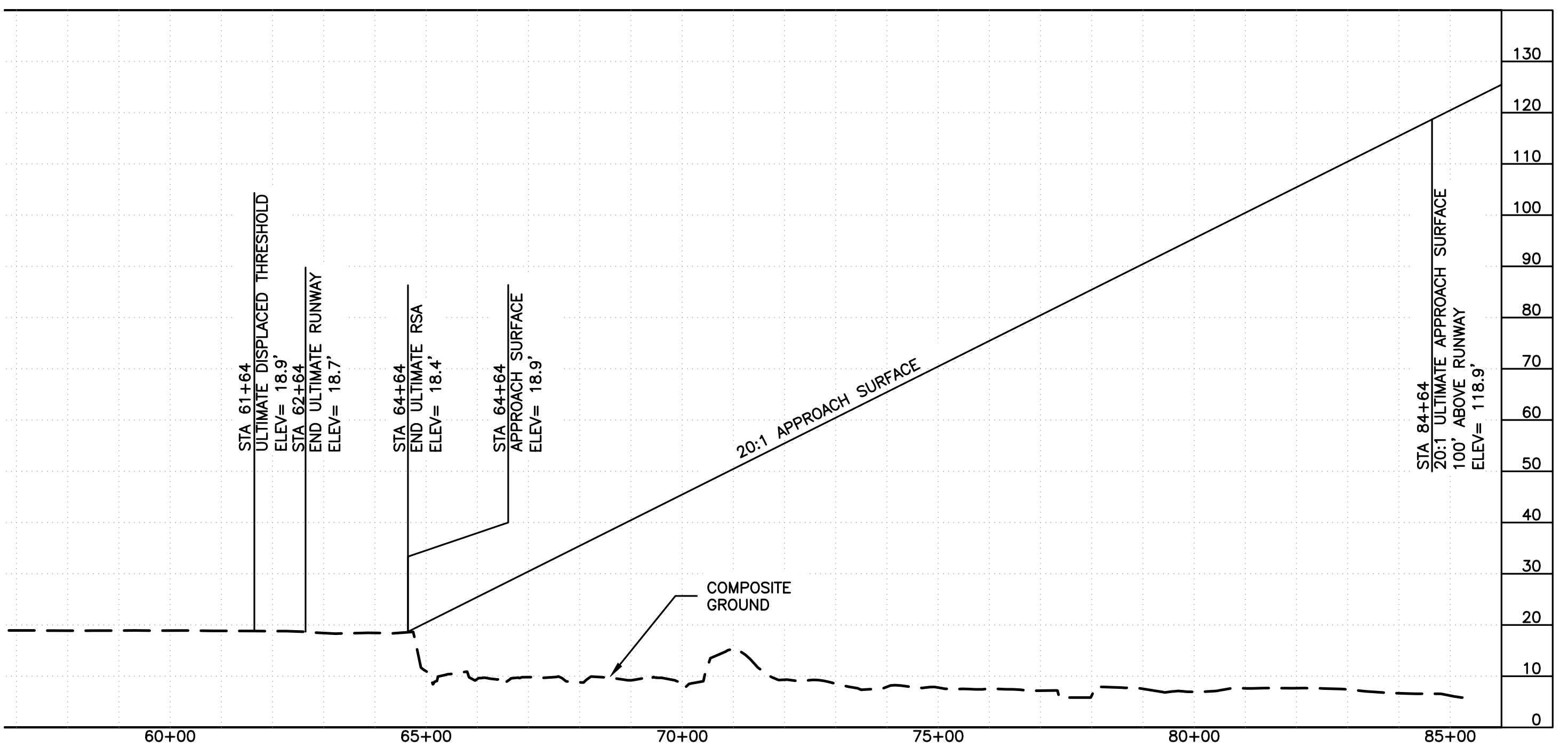
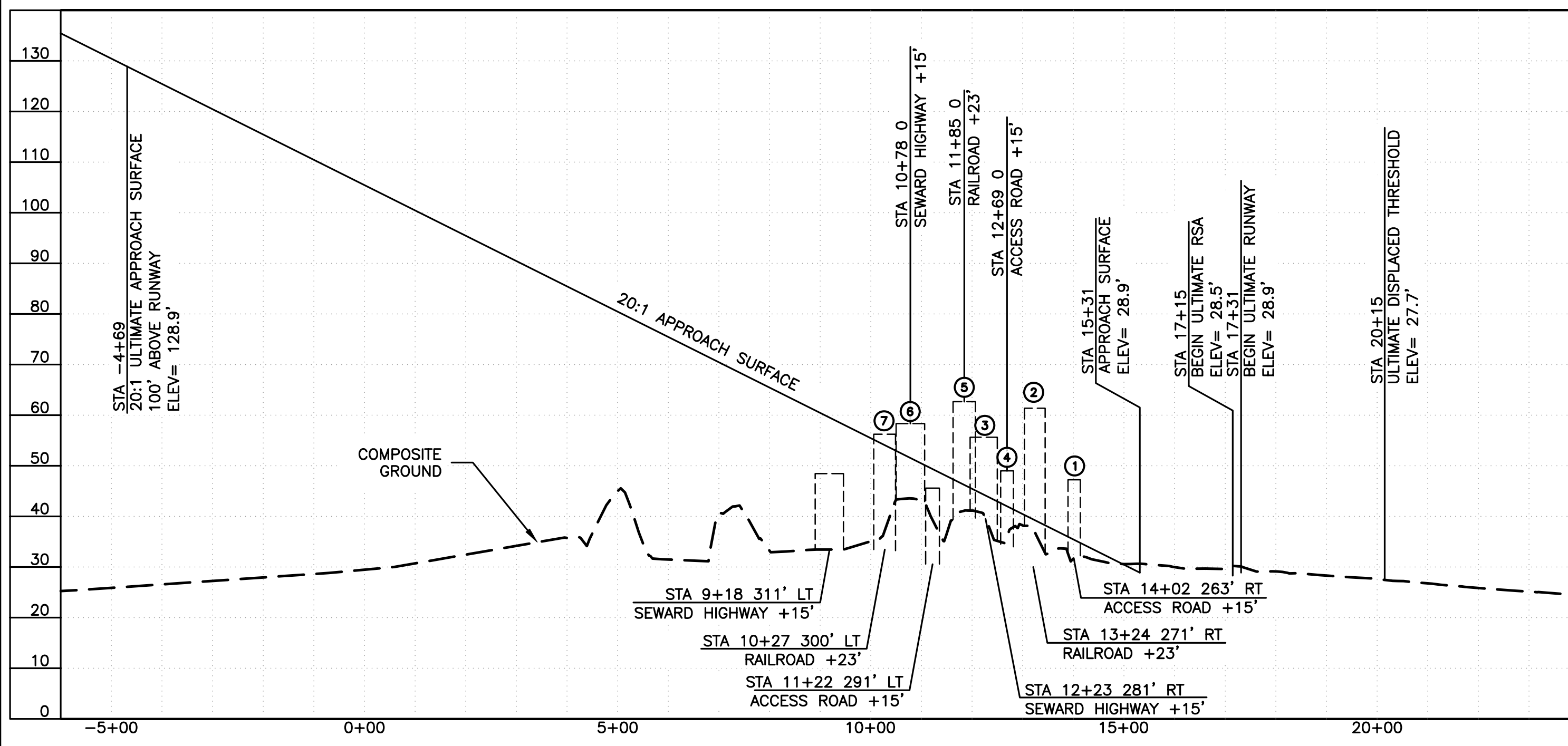
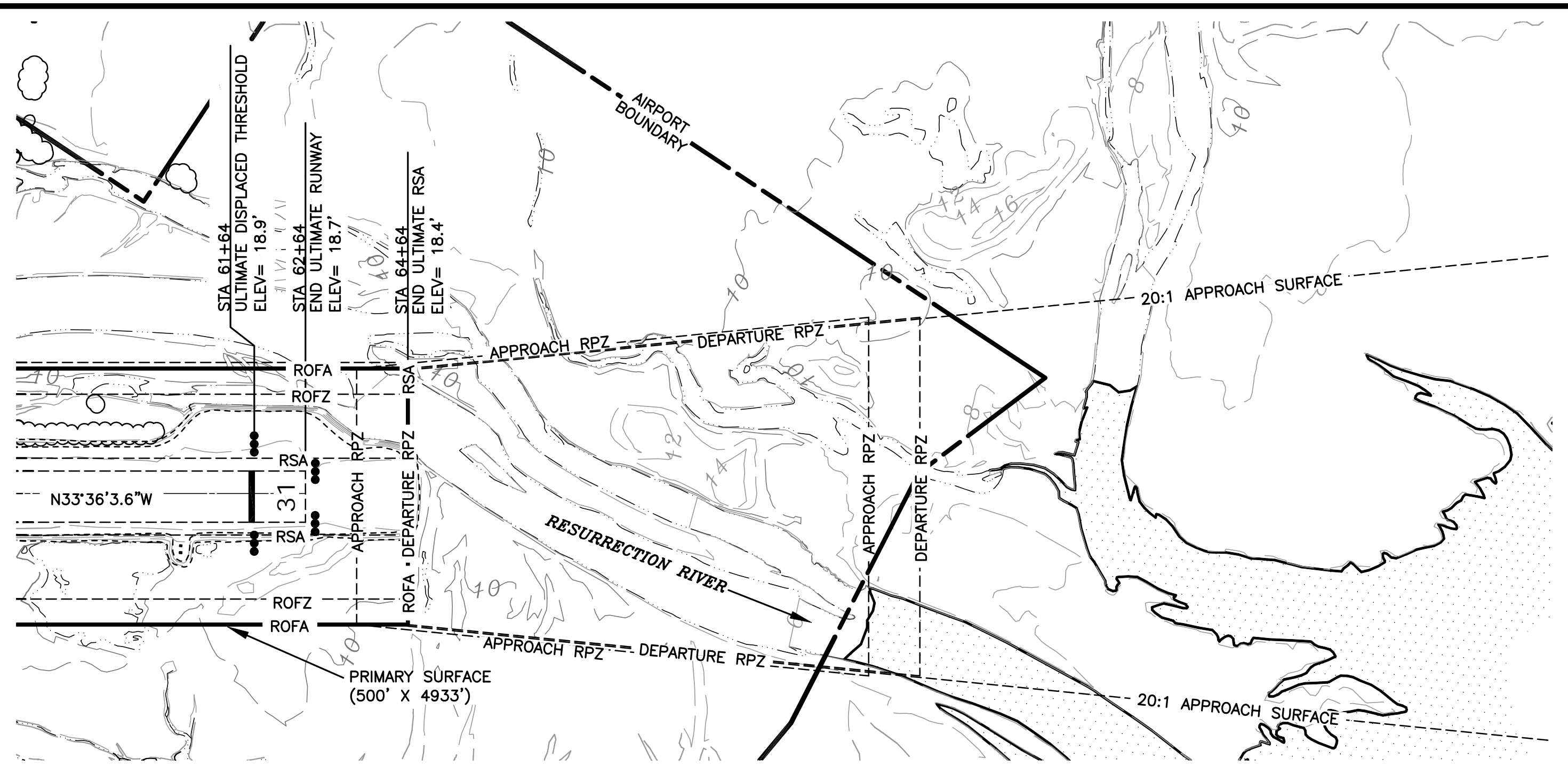
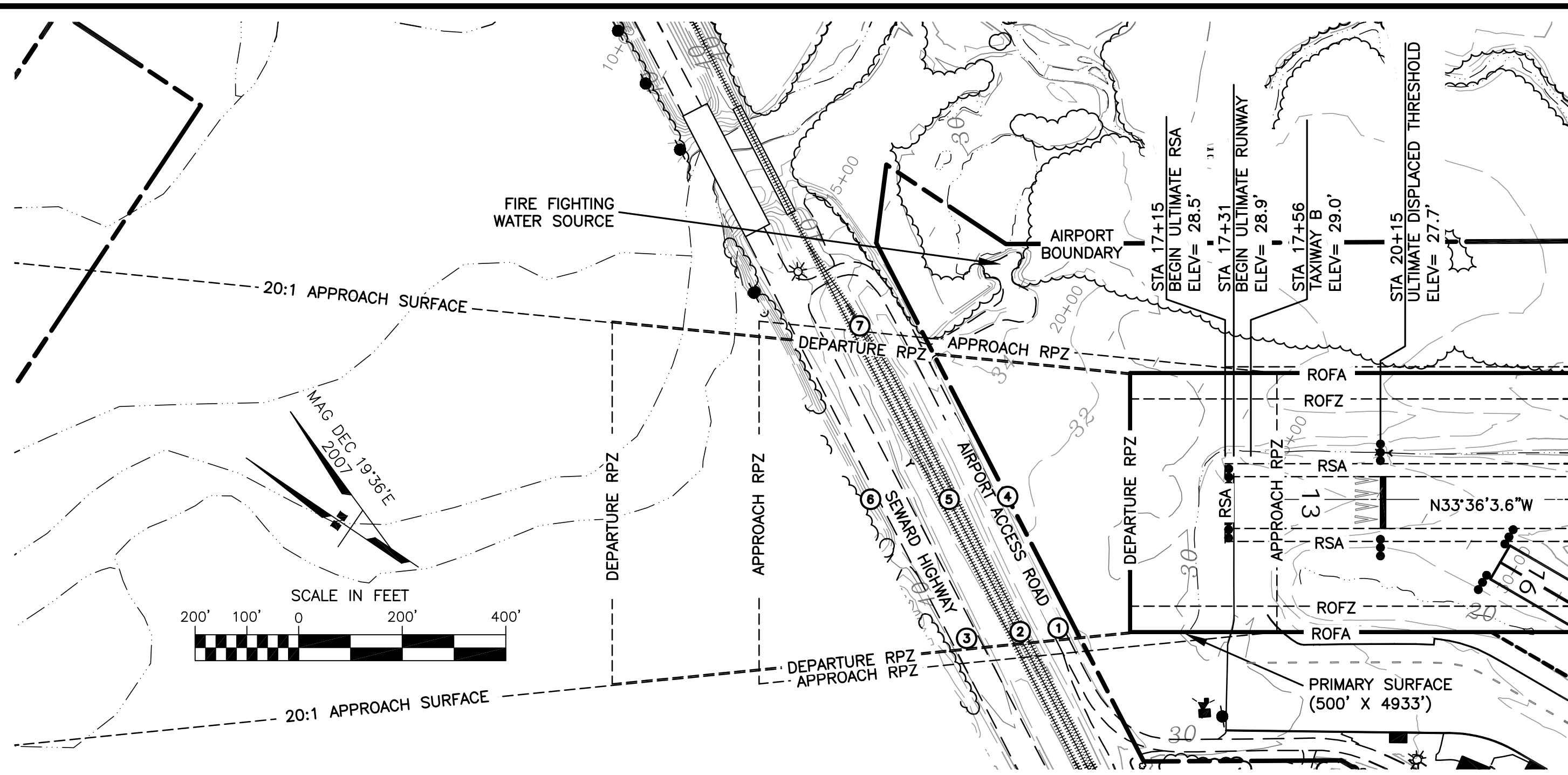

ID #	DESCRIPTION	STATION/OFFSET	ELEVATION	SURFACE PENETRATED	SURFACE ELEVATION	AMOUNT PENETRATION	DISPOSITION	STAGE TO CORRECT
1	AIRPORT ACCESS ROAD	14+02/263' RT	47'	APPROACH	36'	11'	REMAIN	-
2	RAILROAD	13+24/271' RT	61'	APPROACH	39'	22'	REMAIN	-
3	SEWARD HIGHWAY	12+23/281' RT	56'	APPROACH	44'	8'	REMAIN	-
4	AIRPORT ACCESS ROAD	12+69/0	49'	APPROACH	43'	6'	REMAIN	-
5	RAILROAD	11+85/0	63'	APPROACH	46'	18'	REMAIN	-
6	SEWARD HIGHWAY	10+78/0	58'	APPROACH	51'	7'	REMAIN	-
7	RAILROAD	10+27/300' LT	56'	APPROACH	54'	2'	REMAIN	-

NOTES:
 1. THE CONTROLLING OBSTRUCTION FOR THE APPROACH TO RUNWAY 13 IS THE ALASKA RAILROAD AT STA 13+24, 271'R. ELEVATION INCLUDING 23' TRAIN IS 61'. THE EXISTING OBSTRUCTION CLEARANCE SLOPE IS ESTABLISHED AS 15:1 PER FAA AC 150/5200-35, CHAP 4. THE ULTIMATE OBSTRUCTION CLEARANCE SLOPE IS ESTABLISHED AS 12:1 PER FAA AC 150/5200-35, CHAP 4.
 2. THERE ARE NO OBJECT PENETRATIONS IN THE RUNWAY APPROACH END SITING SURFACE OF RUNWAY 13, AS DEFINED IN FAA AC 150/5300-13, CHG 10, APPENDIX 2, TABLE A2-1, LINE 3.

ID #	DESCRIPTION	STATION/OFFSET	ELEVATION	SURFACE PENETRATED	SURFACE ELEVATION	AMOUNT PENETRATION	DISPOSITION	STAGE TO CORRECT
	NONE							

NOTES:
 1. THERE ARE NO OBSTRUCTIONS IN THE APPROACH TO RUNWAY 31. THEREFORE THE OBSTRUCTION CLEARANCE SLOPE IS ESTABLISHED AS 50:1 PER FAA AC 150/5200-35, CHAP 4.
 2. THERE ARE NO OBJECT PENETRATIONS IN THE RUNWAY APPROACH END SITING SURFACE OF RUNWAY 31, AS DEFINED IN FAA AC 150/5300-13, CHG 10, APPENDIX 2, TABLE A2-1, LINE 5.

BY	DATE	REVISION
SEWARD AIRPORT SEWARD, ALASKA AIRPORT LAYOUT PLAN INNER PORTION OF THE APPROACH SURFACE - R/W 13 - 31		
DATE:	07/17/2008	
SHEET:	5	OF 9

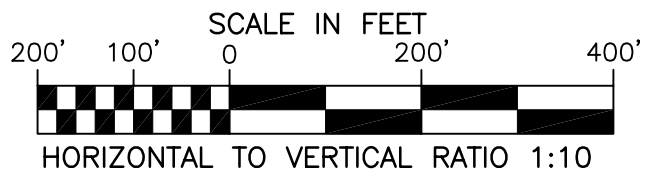
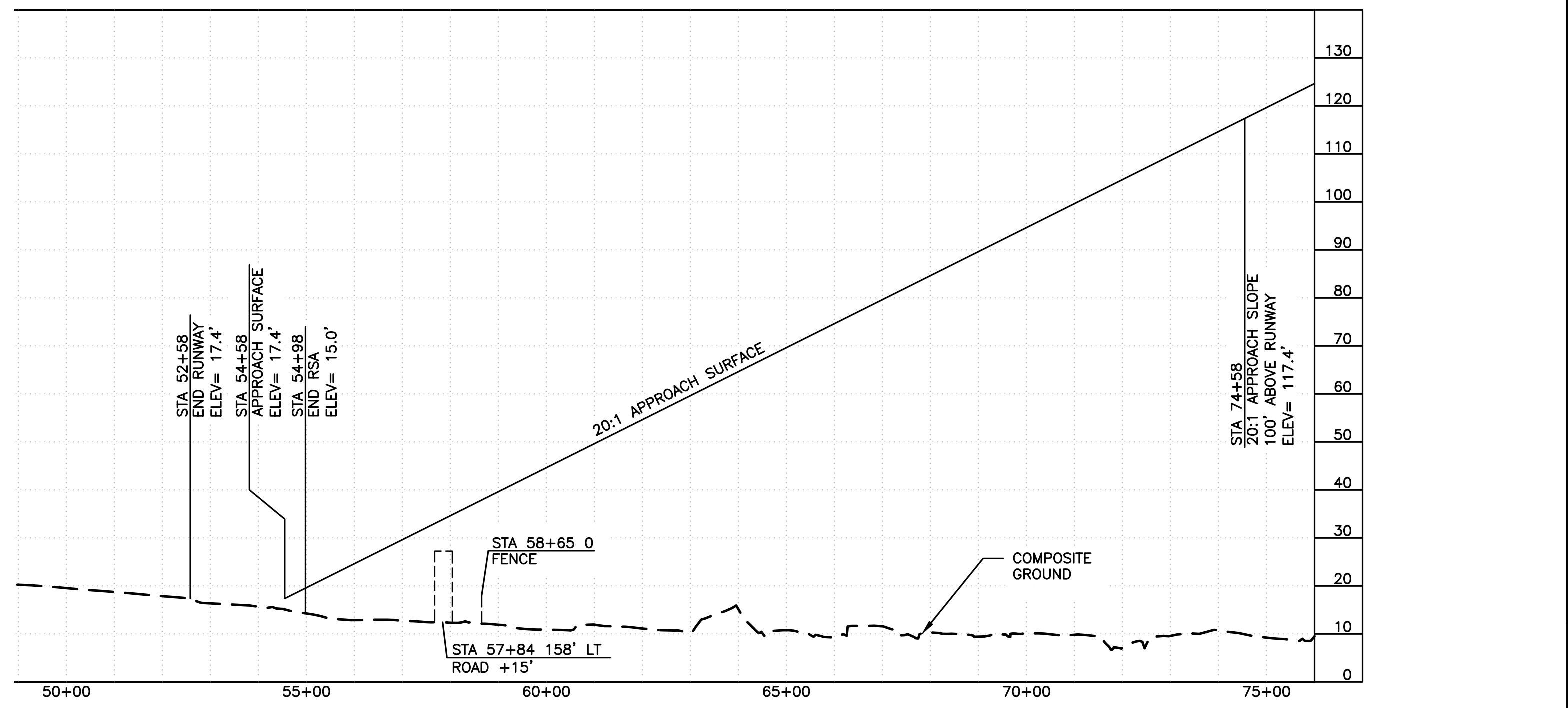
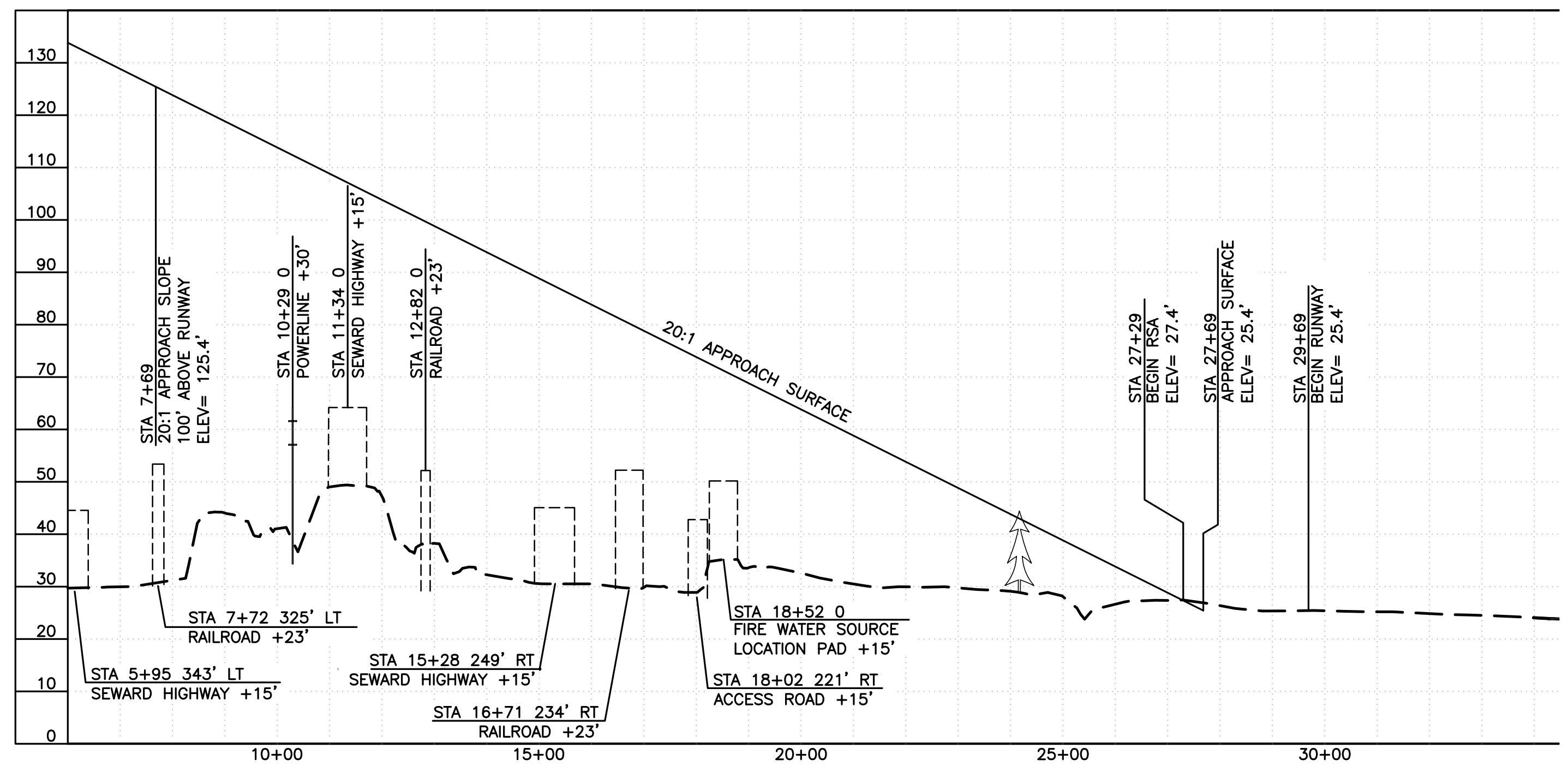
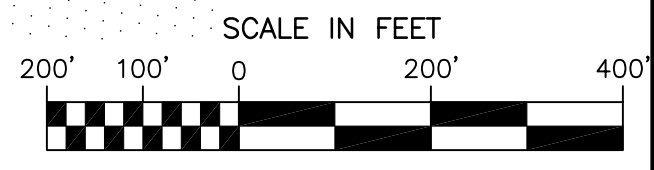
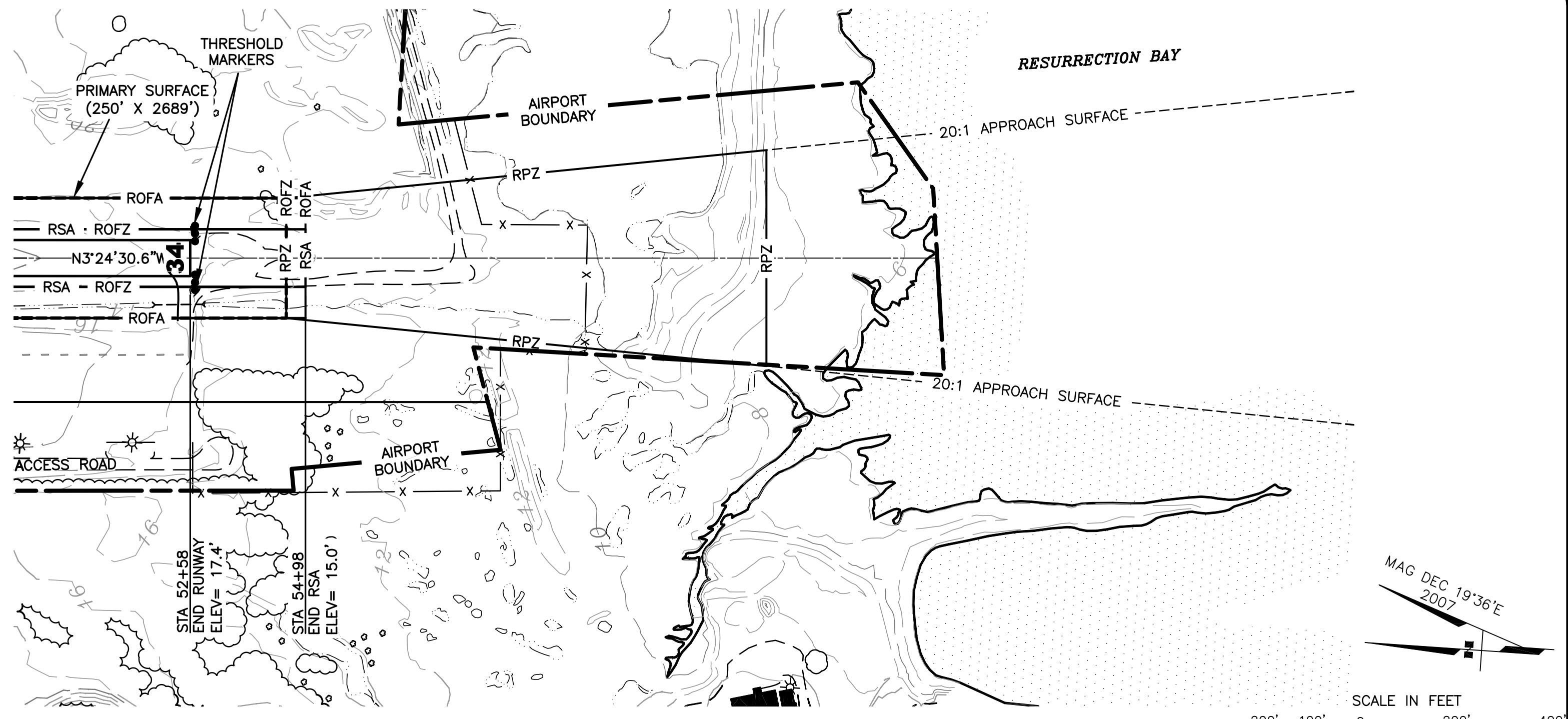
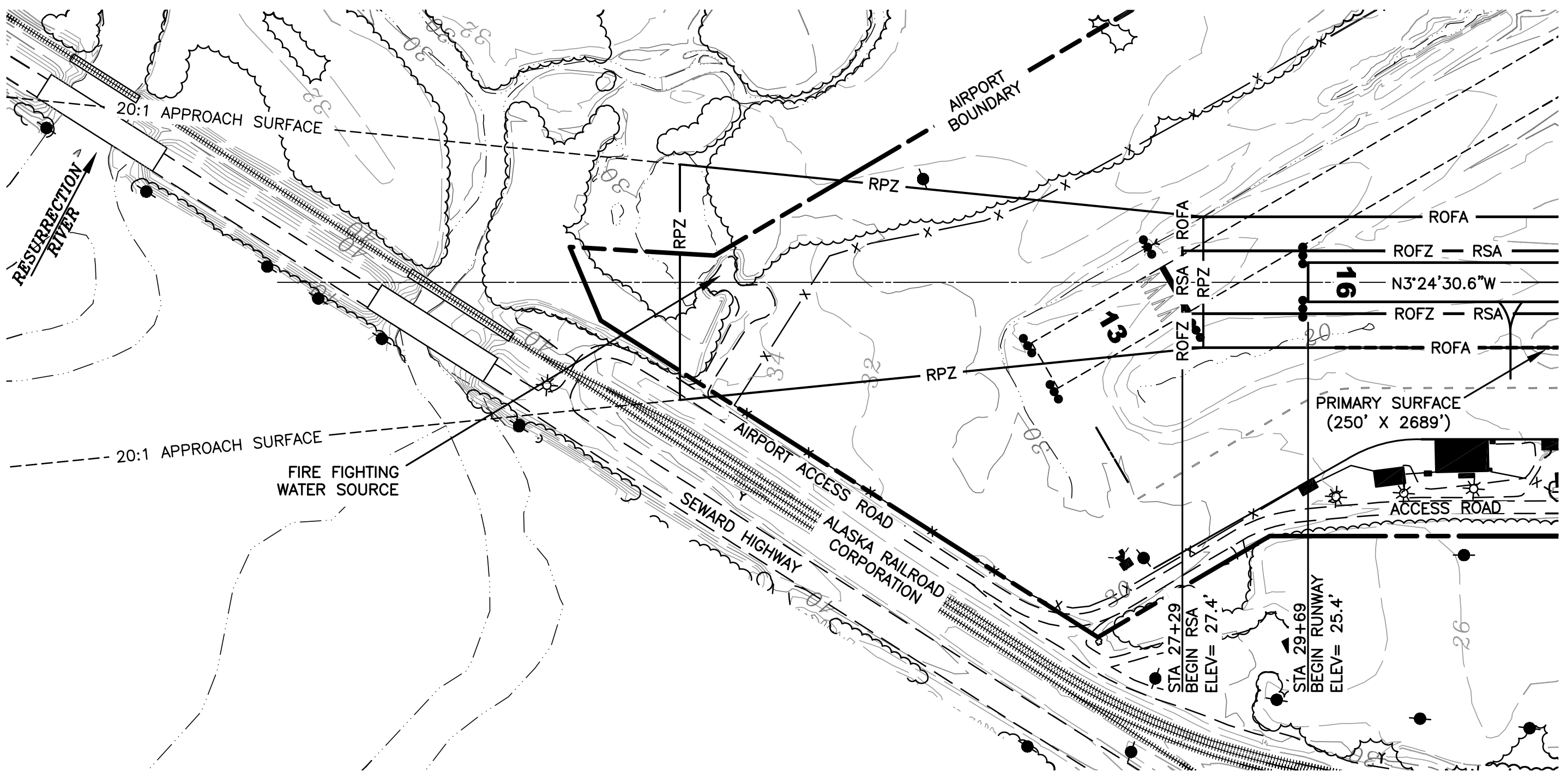

ID #	DESCRIPTION	STATION/OFFSET	ELEVATION	SURFACE PENETRATED	SURFACE ELEVATION	AMOUNT PENETRATION	DISPOSITION	STAGE TO CORRECT
	NONE							

NOTES:
 1. THE CONTROLLING OBSTRUCTION FOR THE APPROACH TO RUNWAY 16 IS TREES AT STA 24+50, 150L. ELEVATION IS APPROXIMATELY 40'. THE OBSTRUCTION CLEARANCE SLOPE IS ESTABLISHED AS 20:1 PER FAA AC 150/5200-35, CHAP 4.
 2. THERE ARE NO OBJECT PENETRATIONS IN THE RUNWAY APPROACH END SITING SURFACE OF RUNWAY 16, AS DEFINED IN FAA AC 150/5300-13, CHG 10, APPENDIX 2, TABLE A2-1, LINE 3.

ID #	DESCRIPTION	STATION/OFFSET	ELEVATION	SURFACE PENETRATED	SURFACE ELEVATION	AMOUNT PENETRATION	DISPOSITION	STAGE TO CORRECT
	NONE							

NOTES:
 1. THERE ARE NOT OBSTRUCTIONS IN THE APPROACH TO RUNWAY 34. THEREFORE THE OBSTRUCTION CLEARANCE SLOPE IS ESTABLISHED AS 50:1 PER FAA AC 150/5200-35, CHAP 4.
 2. THERE ARE NO OBJECT PENETRATIONS IN THE RUNWAY APPROACH END SITING SURFACE OF RUNWAY 34, AS DEFINED IN FAA AC 150/5300-13, CHG 10, APPENDIX 2, TABLE A2-1, LINE 3.

BY	DATE	REVISION

DATE: 07/17/2008
 SHEET: 6 OF 9
**SEWARD AIRPORT
 SEWARD, ALASKA
 AIRPORT LAYOUT PLAN
 INNER PORTION OF THE APPROACH
 SURFACE - R/W 16 - 34**

DOWL FILE No.: 232-104-7

Designed By: jones
 Drawn By: mbauer
 Checked By: branson

Date Plotted: 7/19/2008, 8:27 AM
 Layout Name: P77 (7)
 File Name: P:\Projects\058337\ALP\ALP-SEWARD.dwg

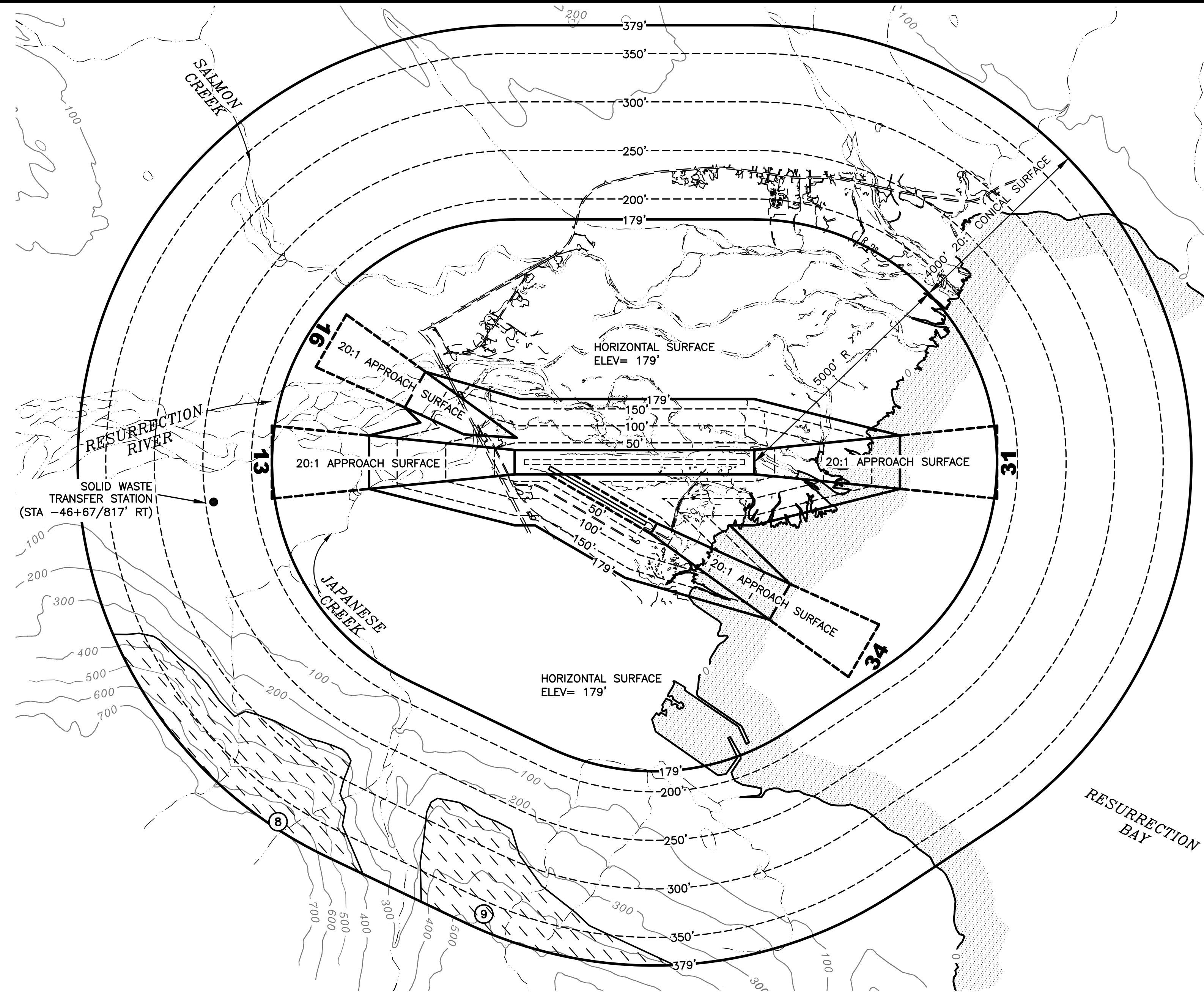

PART 77 SURFACE OBSTRUCTIONS TABLE (OUTER PORTION)								
ID #	DESCRIPTION	STATION/OFFSET	ELEVATION	SURFACE PENETRATED	SURFACE ELEVATION	AMOUNT PENETRATION	DISPOSITION	STAGE TO CORRECT
8	HIGHEST TERRAIN POINT	-33+40/7403' RT	720'	CONICAL	379'	341'	TO REMAIN	N / A
9	HIGHEST TERRAIN POINT	8+95/9301' RT	520'	CONICAL	379'	141'	TO REMAIN	N / A

NOTES

1. TOPO CONTOURS SHOWN IN FEET.
2. PRIMARY SURFACE WIDTH IS 500 FEET FOR RUNWAY 13-31 AND 250 FEET FOR RUNWAY 16-34.
3. PART 77 SURFACES BASED ON ULTIMATE AIRPORT LAYOUT.
4. THERE ARE NO ORDINANCES OR STATUTES IN EFFECT THAT SPECIFY HEIGHT RESTRICTIONS.
5. REFER TO THE INNER PORTION OF THE APPROACH SURFACE DRAWINGS FOR CLOSE-IN OBSTRUCTIONS.
6. ELEVATIONS ESTIMATED FROM USGS TOPO MAPS.

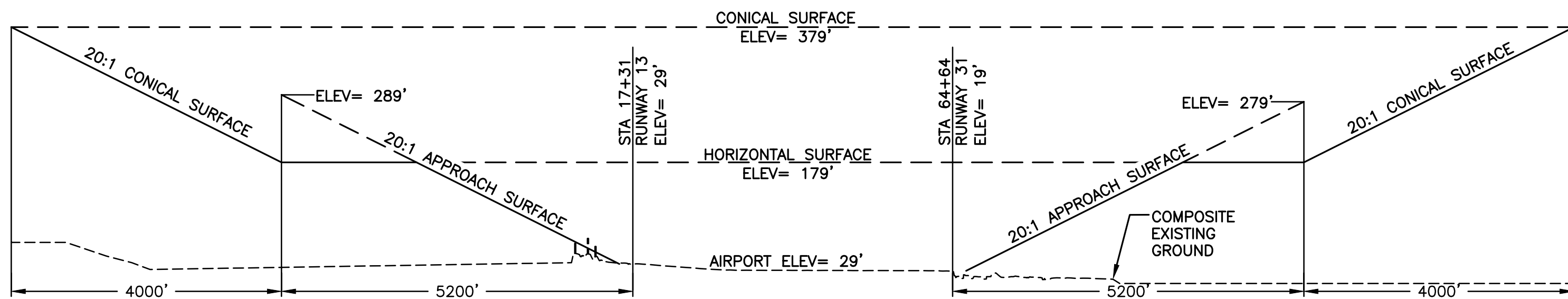
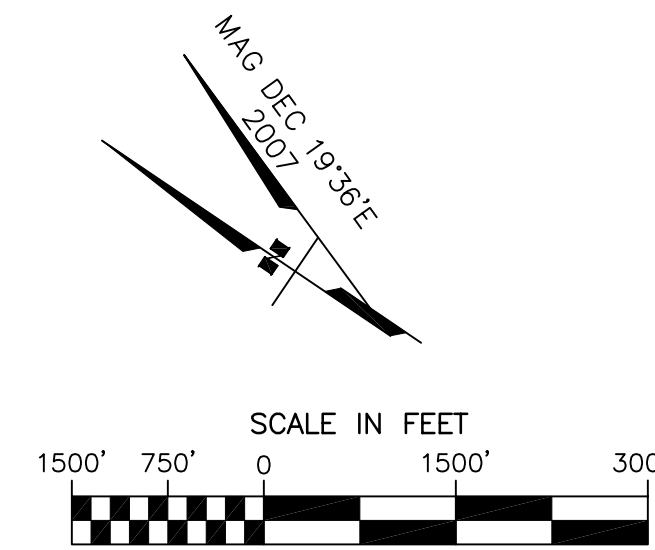

RUNWAY PROFILE 13-31

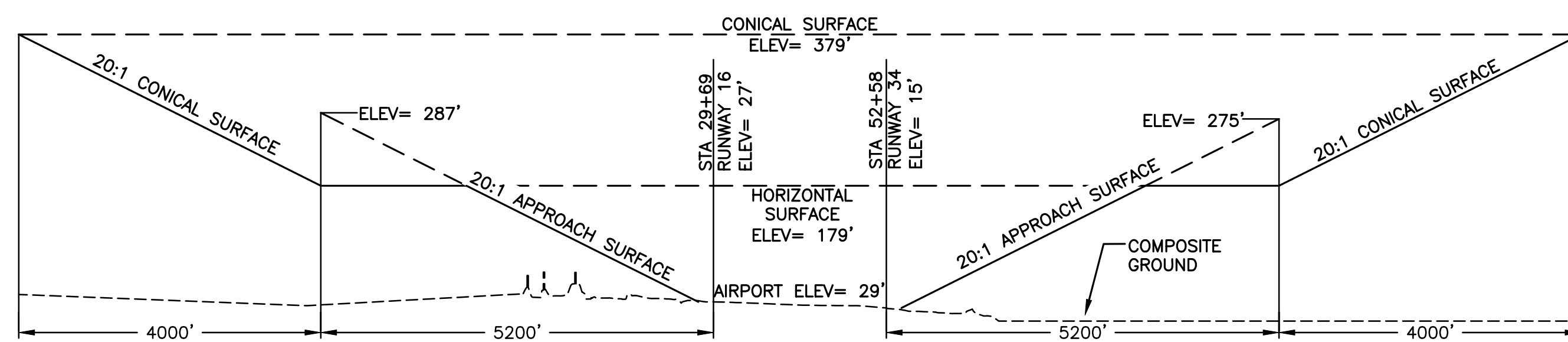
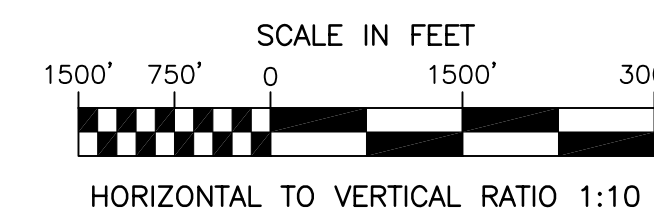

RUNWAY PROFILE 16-34

BY	DATE	REVISION

SEWARD AIRPORT SEWARD, ALASKA AIRPORT LAYOUT PLAN AIRPORT AIRSPACE 14 CFR, PART 77		DATE: 07/17/2008 SHEET: 7 OF 9
--	--	---

DWL FILE No: 232-104-B

Designed By: jones
 Drawn By: mbauer
 Checked By: branson

Date Plotted: 7/19/2008, 8:34 AM
 Layout Name: TERM (8)
 File Name: P:\Projects\058337\ALP\ALP-SEWARD.dwg

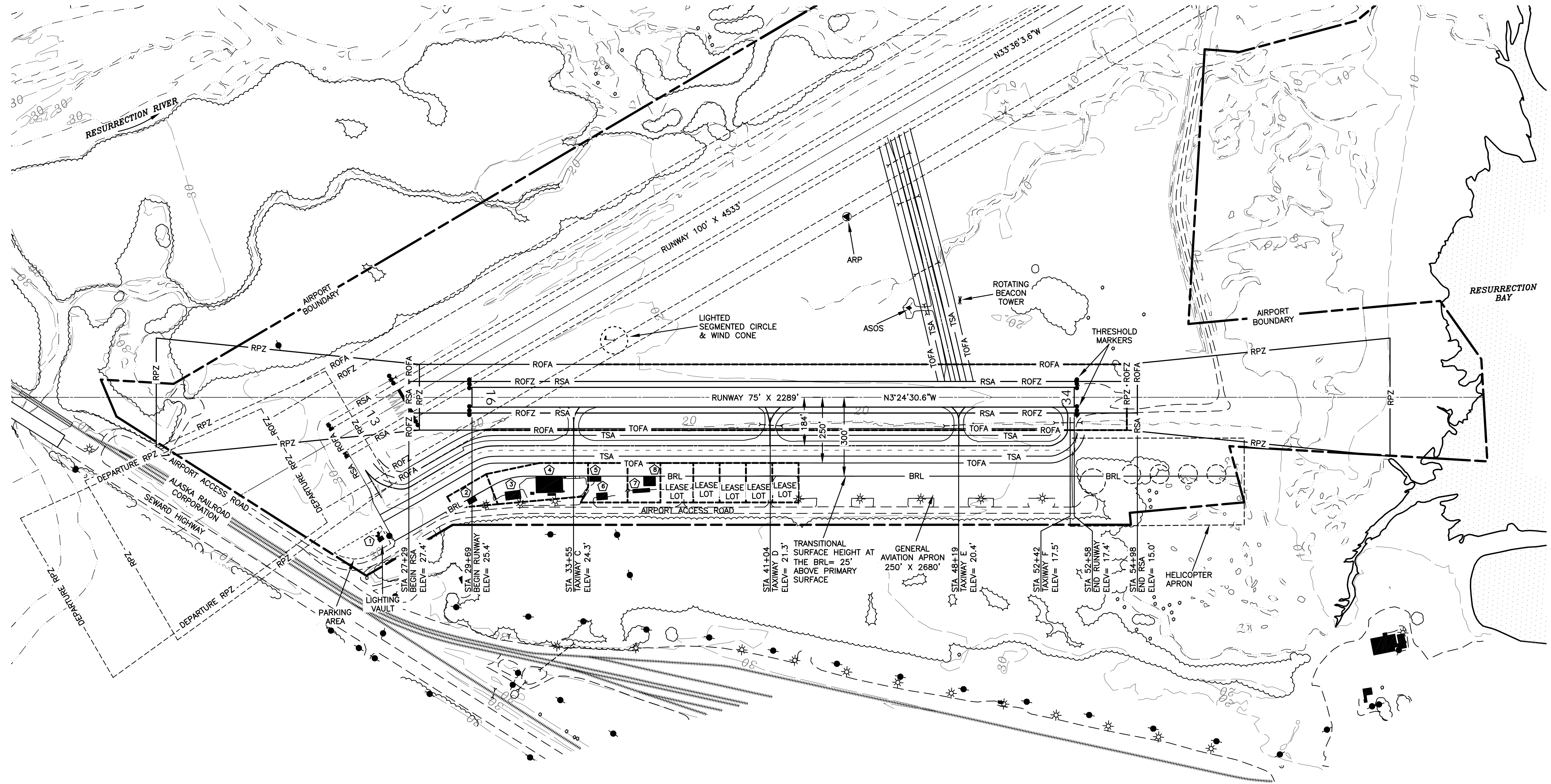

ID #	DESCRIPTION	STATION/OFFSET	TOP ELEV (MSL)	OBSTRUCT MARKING
1	LIGHTING VAULT	26+18/532' RT	40'	NONE
2	SCENIC MTN AIR	29+64/382' RT	43'	NONE
3	FS AIR OFFICE	31+23/357' RT	41'	NONE
4	FS AIR HANGAR	32+62/302' RT	46'	NONE
5	DOTPF SAND STORAGE	34+37/302' RT	36'	NONE
6	DOTPF EQUIPMENT	34+62/364' RT	41'	NONE
7	CIVIL AIR PATROL OFFICE	36+12/348' RT	36'	NONE
8	CIVIL AIR PATROL HANGAR	36+43/300' RT	44'	NONE

NOTE:
BUILDING HEIGHTS ESTIMATED FROM SITE VISIT AND PHOTOGRAPHS.

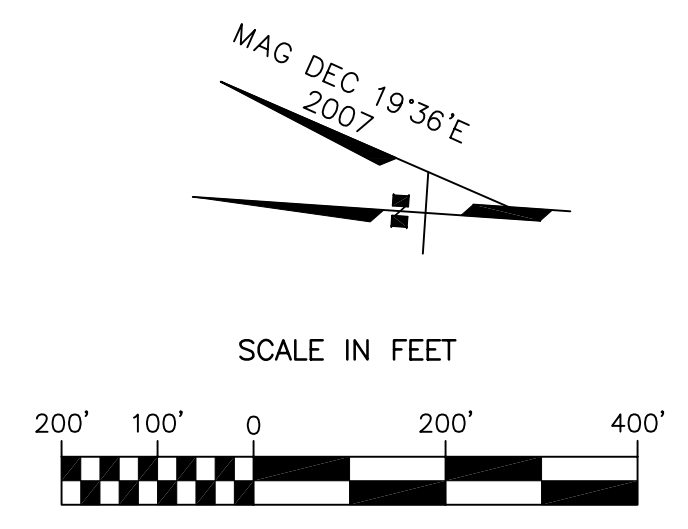

BY	DATE	REVISION

SEWARD AIRPORT
 SEWARD, ALASKA
 AIRPORT LAYOUT PLAN
 TERMINAL AREA

DATE: 07/17/2008
 SHEET: 8 OF 9

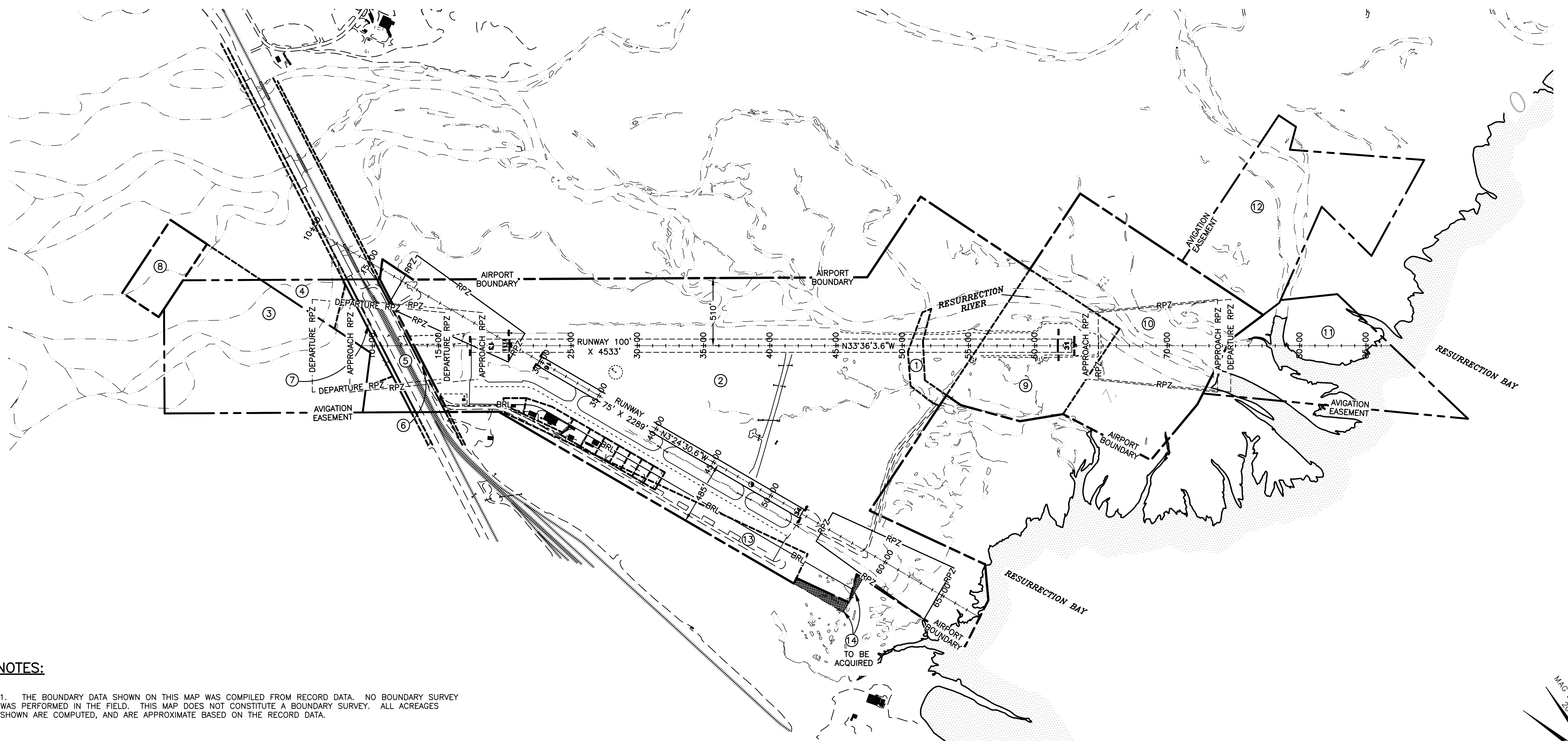

NOTES:

1. THE BOUNDARY DATA SHOWN ON THIS MAP WAS COMPILED FROM RECORD DATA. NO BOUNDARY SURVEY WAS PERFORMED IN THE FIELD. THIS MAP DOES NOT CONSTITUTE A BOUNDARY SURVEY. ALL ACREAGES SHOWN ARE COMPUTED, AND ARE APPROXIMATE BASED ON THE RECORD DATA.

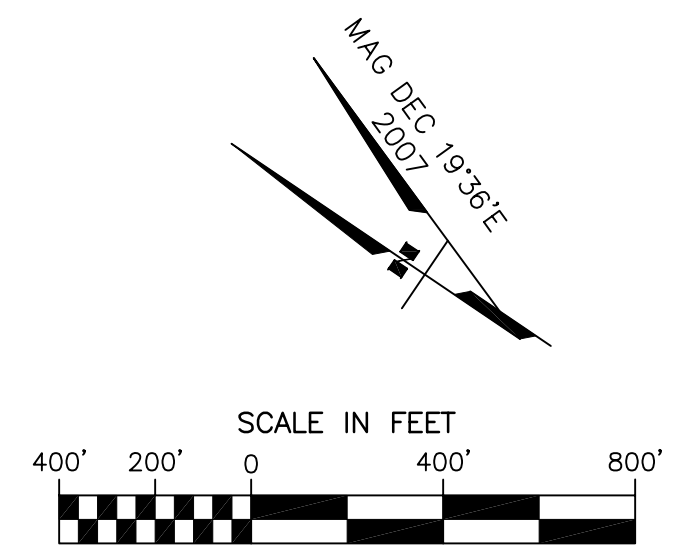

ID #	INTEREST	GRANTOR	GRANTEE	PARCEL SIZE	DATE ACQUIRED	RECORDED DOC NO.	ACQUIRED AIP NO.
①	PATENT FOR AIRPORT PURPOSES QUIT CLAIM DEED	UNITED STATES OF AMERICA CITY OF SEWARD, ALASKA	STATE OF ALASKA, DOT&PF STATE OF ALASKA, DOT&PF	1.723 AC.± 1.723 AC.±	03-01-1955 10-28-1992	BK. 2 P, PG. 19 BK. 67, PG. 336	FAAP 9-50-003-101 -
②	DEFAULT JUDGMENT DEFAULT JUDGMENT CORRECTED FOR CLERICAL MISTAKE DEFAULT JUDGMENT CORRECTING CORRECTED DEFAULT JUDGMENT FOR CLERICAL MISTAKE	SUPERIOR COURT, STATE OF ALASKA SUPERIOR COURT, STATE OF ALASKA SUPERIOR COURT, STATE OF ALASKA	STATE OF ALASKA, DOT&PF STATE OF ALASKA, DOT&PF STATE OF ALASKA, DOT&PF	165.957 AC.± 165.957 AC.± 165.957 AC.±	03-06-1964 07-19-1964 09-28-1967	BK. 37 R, PG. 72 C.J. D3, PG. 40 BK. 45 R, PG. 183	FAAP 9-50-003-5902 - -
③	PERPETUAL AVIGATION & HAZARD EASEMENT PERPETUAL AVIGATION & HAZARD EASEMENT	VETERANS HOUSING COMPANY, INC. WOMEN'S DIVISION OF CHRISTIAN SERVICE OF THE BOARD OF MISSIONS OF THE METHODIST CHURCH	STATE OF ALASKA, DOT&PF STATE OF ALASKA, DOT&PF	29.954 AC.± 6.675 AC.±	02-05-1963 09-27-1963	BK. 35 R, PG. 192 BK. 36 R, PG. 237	FAAP 9-50-003-5902 FAAP 9-50-003-5902
④	AIRSPACE PERMIT	ALASKA RAILROAD CORPORATION	STATE OF ALASKA, DOT&PF	5.171 AC.±	08-08-1991	BK. 61, PG. 957	AKSAS 58156
⑤	PERPETUAL AVIGATION & HAZARD EASEMENT	STATE OF ALASKA, DOH	STATE OF ALASKA, DOT&PF	0.502 AC.±	01-31-1963	(ADA 10332)	FAAP 9-50-003-5902
⑥	PERPETUAL AVIGATION & HAZARD EASEMENT	STATE OF ALASKA, DOH	STATE OF ALASKA, DOT&PF	0.776 AC.±	01-31-1963	(ADA 10332)	FAAP 9-50-003-5902
⑦	INTERAGENCY LAND MANAGEMENT AGREEMENT	STATE OF ALASKA, DNR	STATE OF ALASKA, DOT&PF	5.00 AC.±	11-15-1963	BK. 19, PG. 739	FAAP 9-50-003-C603
⑧	FEE SIMPLE - WARRANTY DEED	HERMAN E. AND WINIFRED I. LEIRER	STATE OF ALASKA, DOT&PF	19.125 AC.±	09-15-1965	BK. 30 D, PG. 73	FAAP 9-50-003-C603
⑨	FEE SIMPLE - WARRANTY DEED	DAVID W. CARLSON	STATE OF ALASKA, DOT&PF	38.111 AC.±	11-11-1968	BK. 32 D, PG. 194	FAAP 9-50-003-C603
⑩	PERPETUAL AVIGATION & HAZARD EASEMENT	CITY OF SEWARD, ALASKA	STATE OF ALASKA, DOT&PF	23.595 AC.±	06-05-1967	BK. 44 R, PG. 180	FAAP 9-50-003-C603
⑪	PERMIT, AVIGATION & HAZARD EASEMENT & ROW	HERMAN E. AND WINIFRED I. LEIRER	STATE OF ALASKA, DOT&PF	27.948 AC.±	02-13-1970	BK. 48 R, PG. 374	FAAP 9-50-003-C603
⑫	35-YEAR PUBLIC AIRPORT LEASE	ALASKA RAILROAD CORPORATION	STATE OF ALASKA, DOT&PF	7.545 AC.±	02-01-1991	BK. 61, PG. 937	AKSAS 58156
⑬	TO BE ACQUIRED	ALASKA RAILROAD CORPORATION	STATE OF ALASKA, DOT&PF	0.8 AC.±	-	-	-

BY	DATE	REVISION

SEWARD AIRPORT SEWARD, ALASKA AIRPORT LAYOUT PLAN		DATE: 07/17/2008
PROPERTY MAP		SHEET: 9 OF 9