

SCALE: 1" = 1 MILE  
 PROTRACTED SECTIONS 21 & 22  
 TOWNSHIP 18 NORTH, RANGE 9 EAST  
 KATEEL RIVER MERIDIAN, ALASKA  
 U.S.G.S. MAP SHUNGNAK (D-2)

LOCATION MAP  
NO SCALE

VICINITY MAP  
SCALE: 1" = 1 MILE

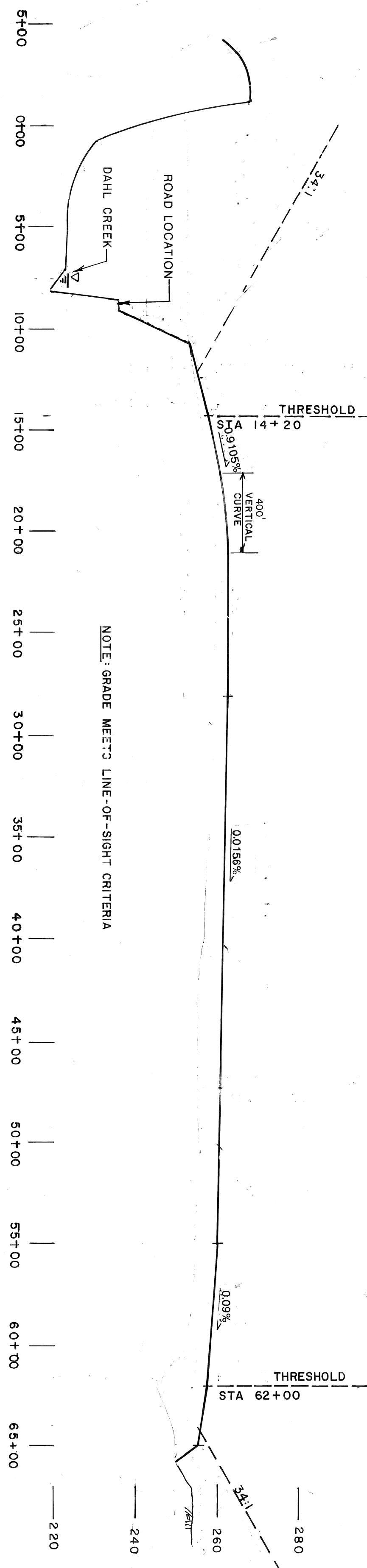

NOTE: GRADE MEETS LINE-OF-SIGHT CRITERIA

RUNWAY PROFILE  
 SCALE: HORIZONTAL 1" = 400'  
 VERTICAL 1" = 20'

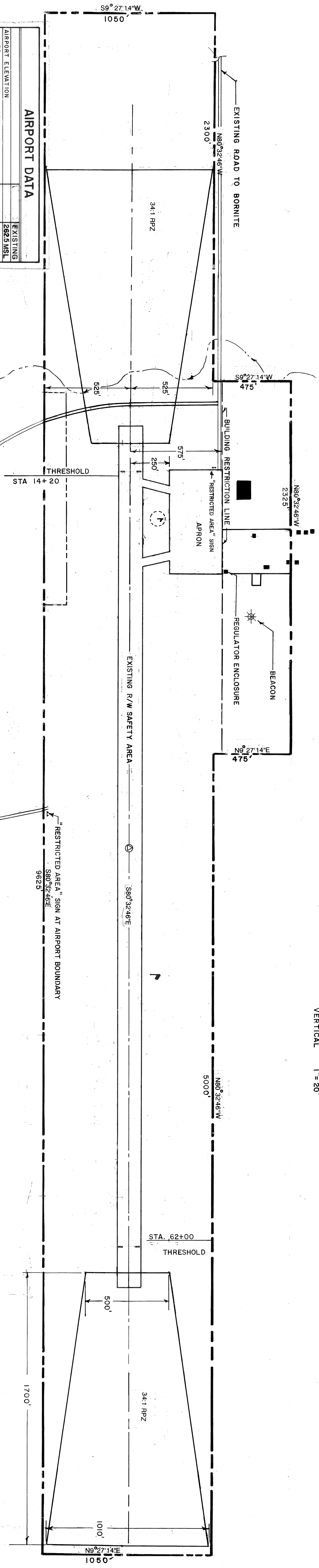

AIRPORT DATA

AIRPORT ELEVATION	EXISTING	2625 MSL
MEAN TEMPERATURE (JULY)		72°F
TAXIWAY LIGHTING		NONE
RAMP LIGHTING		NONE
AIRPORT REFERENCE POINT (A.R.P.)		LAT 66° 57' N - LONG 156° 54' E
AIRPORT B TERMINAL NAME		APPROACH DESIGN
DESIGN TYPE		CAN B
SERVICE LEVEL		DESIGN

RUNWAY DATA

ITEM	EXISTING	EXISTING	FUTURE
EFFECTIVE GRADE	0.103%		
INSURMENT RUNWAY	N/A		
PAVEMENT SURFACE	GRAVEL		
APPROACH SURFACES	N/A		
APPROACH LIGHTING	REFL. MKRS		
RUNWAY MARKING	NONE		
NAVIGATION AIDS	NONE		
RUNWAY SAFETY AREA	150' X 330'		
RUNWAY DIMENSION	734' X 780'		

DEVIATION FROM DESIGN STANDARDS

ITEM	STANDARD	EXISTING
RUNWAY WIDTH	100'	73'
RUNWAY SHOULDER WIDTH	20'	10'
RUNWAY SAFETY AREA WIDTH	500'	150'
RUNWAY SAFETY AREA LENGTH BEYOND	1000'	300'
RUNWAY CENTERLINE TO:		
PROPERTY BOUNDARY	100'	450'
AIRPORT BUILDING RESTRICTION LINE	750'	525'/575'

\* NO SURFACE MARKINGS EXIST

WIND DATA

-PILOT REPORTS INDICATE RUNWAY IS ALIGNED WITH PREVAILING WINDS - NO KNOWN RECORDED DATA

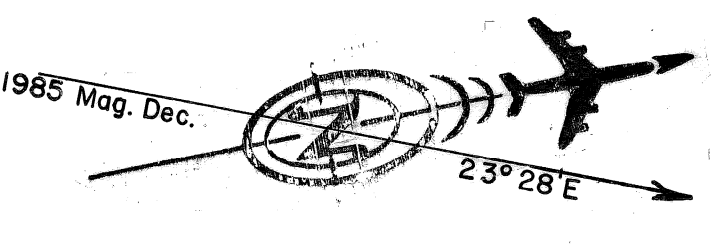

LEGEND

PROPERTY LINE	EXISTING
BUILDING RESTRICTION LINE (B.R.L.)	EXISTING
AVIATION AND HAZARD ESTABLISHMENT	NONE
FACILITIES	NONE
AIRPORT REFERENCE POINT	▲
WIND CONE & SEG. CIR. (UNLIGHTED)	○
WIND CONE (UNLIGHTED)	○
ROTATING BEACON	○
BUILDINGS	■
ROADWAYS	—
PROPERTY TO BE ACQUIRED	---

SCALE 1" = 300'

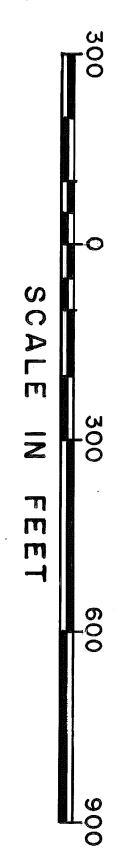

DAHL CREEK AIRPORT

AIRPORT LAYOUT PLAN

SHEET 1 OF 1

DESIGN: **DAB**  
 DRAWN: **LK**  
 CHECKED: **DAB**

DATE: 9/9/93 AS BUILT

REVISIONS:

NO.	DATE	DESCRIPTION
1	5/9/86	FAA APPROVED
2	3/24/86	CHANGED TO TRANSPORT CENTER, EXPANDED APRON AND WIDER TAXIWAYS FOR LARGE VESSEL, ADDED RUNWAY PROFILE AND NOTES, ADDED DEVIATIONS TABLE.
3	3/11/86	BRL LOCATION, ADDED TAXIWAY
4	2/10/86	APRON AND BRL LOCATION
5	1/13/86	FAA APPROVAL
6	8/19/85	FAA APPROVAL

STATE OF ALASKA  
 DEPARTMENT OF TRANSPORTATION AND PUBLIC FACILITIES  
 NORTHERN REGION - DESIGN AND CONSTRUCTION - AVIATION

APPROVED: *Daniel D. Urbach, P.E.* DATE: 7-26-85  
 CHIEF AVIATION DESIGN GROUP

DESIGN: **DAB**  
 DRAWN: **LK**  
 CHECKED: **DAB**