

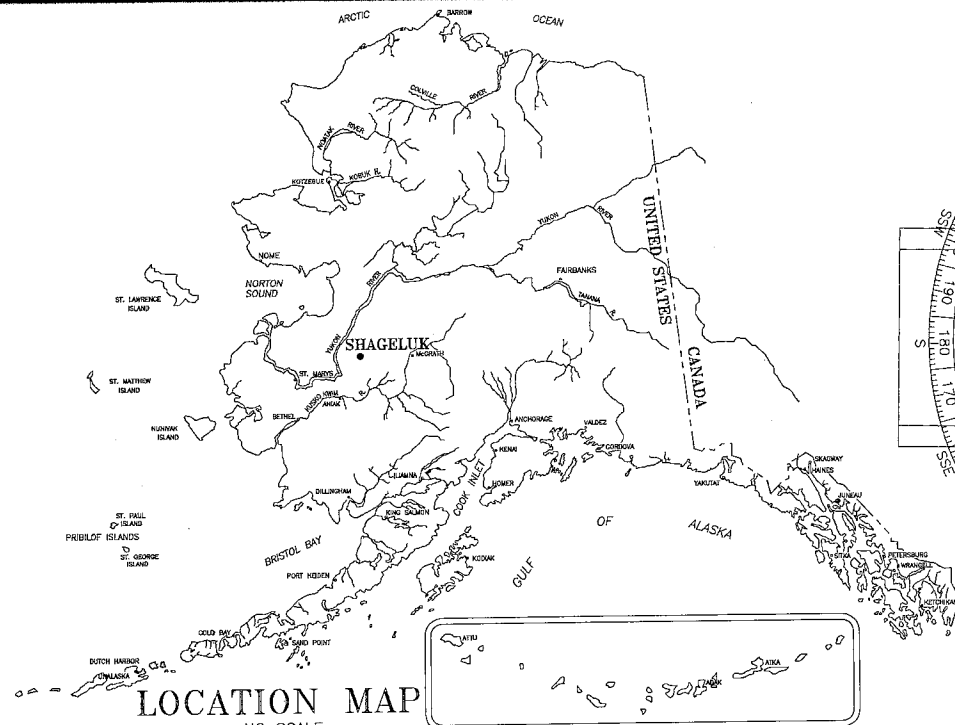

VICINITY MAP
T.30N., R.55W.
SEWARD MERIDIAN
SECTIONS 10 and 15
NO SCALE

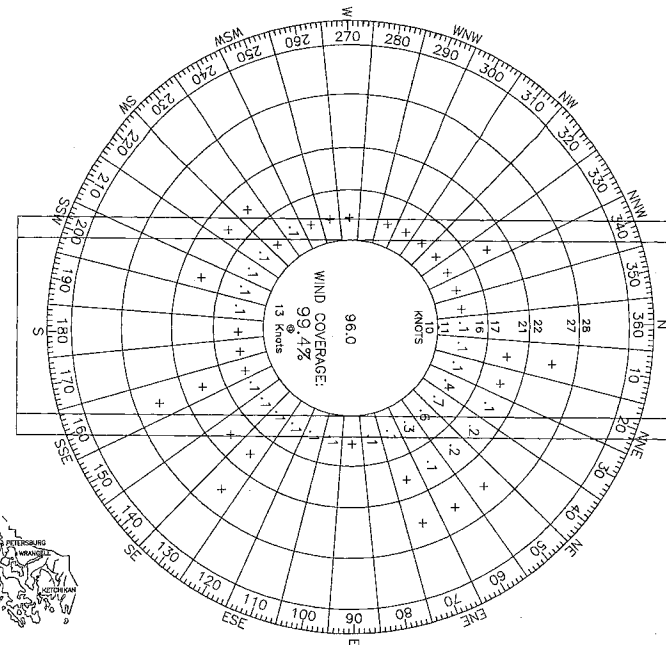

LOCATION MAP
NO SCALE



ALASKA STATE CLIMATE CENTER
ENVIRONMENT and NATURAL RESOURCES INSTITUTE
UNIVERSITY OF ALASKA-ANCHORAGE
9 MAY 1996 - 14 JULY 1997

WIND COVERAGE

RUNWAY	GROUP	CROSSWIND COMPONENT	COVERAGE
16-34	I	10.5 kts	98.5%
	II	13 kts	99.4%

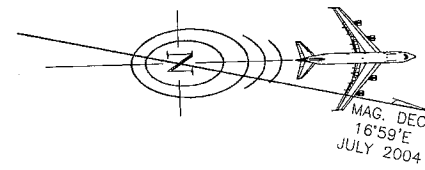

LEGEND

ITEM	EXISTING
PROPERTY LINE	---
BUILDING RESTRICTION LINE (BRL)	---
AVIGATION & HAZARD EASEMENT	---
OBJECT FREE AREA	---
OBSTACLE FREE ZONE	---
RUNWAYS, TAXIWAYS, & APRON	---
RUNWAYS & TAXIWAYS SAFETY AREA	---
AIRPORT REFERENCE POINT (A.R.P.)	⊙
WIND CONE and SEGMENTED CIRCLE	⊙
ROTATING BEACON	⊙
ROADWAYS	---
BUILDINGS	---
FUEL TANK	---
CONTOURS	---
RIVER	---
LAKE	---
RAIL	---

RUNWAY DATA TABLE

ITEM	RUNWAY 16/34	
	EXISTING	ULTIMATE
EFFECTIVE GRADE	0.00%	SAME
% WIND COVERAGE	99.4%	SAME
INSTRUMENT RUNWAY	R/W 34	SAME
RUNWAY SURFACE	GRAVEL	SAME
PAVEMENT STRENGTH (LBS.)	N/A	SAME
APPROACH SURFACES	34:1	SAME
VISIBILITY MINIMUM	>=1mile	SAME
RUNWAY LIGHTING	M.I.R.L.	SAME
RUNWAY MARKING	NONE	SAME
NAVIGATION AIDS	NONE	SAME
RUNWAY SAFETY AREA DIMENSION	150ft x 4000ft	SAME
RUNWAY DIMENSION	75ft x 3400ft	SAME
RUNWAY OBJECT FREE AREA DIMENSION	500ft x 4000ft	SAME
RUNWAY OBSTACLE FREE ZONE DIMENSION	400ft x 3800ft	SAME
GEODETIC POSITIONS (N.A.D. 83)		SAME
	THRESHOLD 16	LAT. 62°41'49.01"N
		LONG. 159°34'09.36"W
	THRESHOLD 34	LAT. 62°41'15.54"N
		LONG. 159°34'08.96"W

BUILDING DATA TABLE

#	STRUCTURE NAME	TOP ELEV.	OBSTRUCTION MARKING (Y/N)	REMARKS
1	NEW SREB	132.6'	N N	NO PENETRATION
2	OLD SREB	N/A	N N	TO BE REMOVED
3	OLD FUEL BLDG	N/A	N N	TO BE REMOVED
4	OLD ELECTRICAL BLDG	N/A	N N	TO BE REMOVED

AIRPORT DATA TABLE

ITEM	EXISTING	ULTIMATE
AIRPORT ELEVATION (M.S.L.)	108.75'	SAME
AIRPORT REFERENCE POINT (A.R.P.) (N.A.D. 83)	62°41'32.27"N 159°34'09.16"W	SAME
TAXIWAY LIGHTING	M.I.T.L.	SAME
RAMP LIGHTING	FLOOD	SAME
MEAN MAX. TEMPERATURE, HOTTEST MONTH (JULY)	N/A	SAME
MAGNETIC DECLINATION, YEAR	10.5'W per year	SAME
AIRPORT REFERENCE CODE	B-II	SAME
AIRPORT AND TERMINAL NAVIGATION AIDS	PAPI AND REIL	SAME
TAXIWAY DIMENSIONS	50' x 250'	SAME
TAXIWAY SAFETY AREA DIMENSIONS	79' x 250'	SAME
TAXIWAY OBJECT FREE AREA WIDTH	131'	SAME

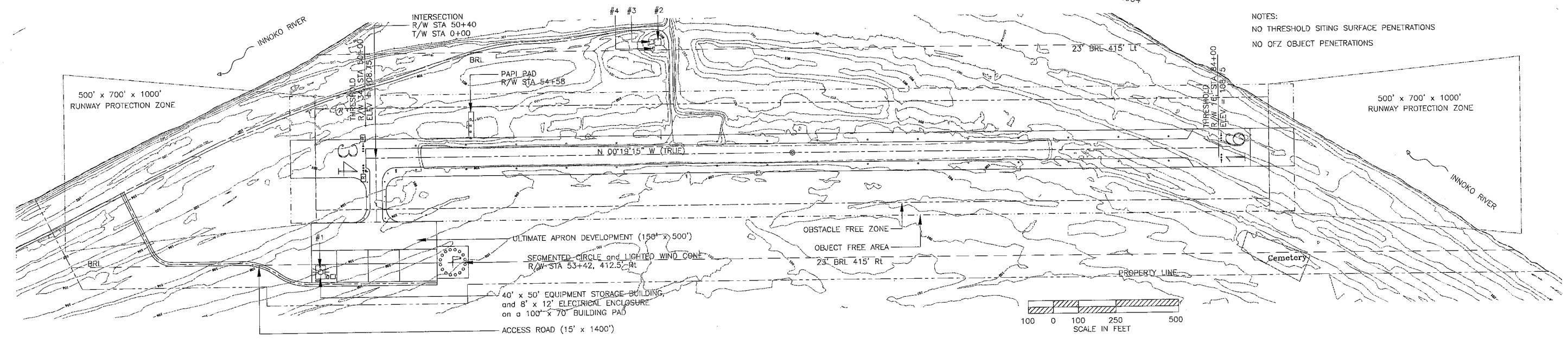

NOTES:
NO THRESHOLD SITING SURFACE PENETRATIONS
NO OFZ OBJECT PENETRATIONS

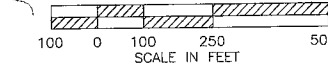

DESIGN	OCU	
DRAWN	OCU	
CHECKED	jjc	
BY	DATE	REVISIONS
	8/17/04	AS-BUILT

STATE OF ALASKA
DEPARTMENT OF TRANSPORTATION AND PUBLIC FACILITIES
NORTHERN REGION-DESIGN AND ENGINEERING SERVICES

APPROVED: *Patricia D. Miller* DATE: *8/11/04*
PATRICIA D. MILLER, P.E. DESIGN GROUP CHIEF

AIRPORT LAYOUT PLAN APPROVED
BY LETTER DATED: *6/30/04*
J. T. Smith
AIRPORTS DIVISION,
ALASKAN REGION, AAL-601
AIRSPACE REVIEW #99AAL-079NRA

THIS ALP SUPERCEDES THE ALP DATED 2/5/99 AND IS BASED
ON THE AS-BUILT FOR AIP 3-02-0370-02 DATED 11/13/03

SHAGELUK AIRPORT
AIRPORT LAYOUT PLAN

SHEET
1 OF
3

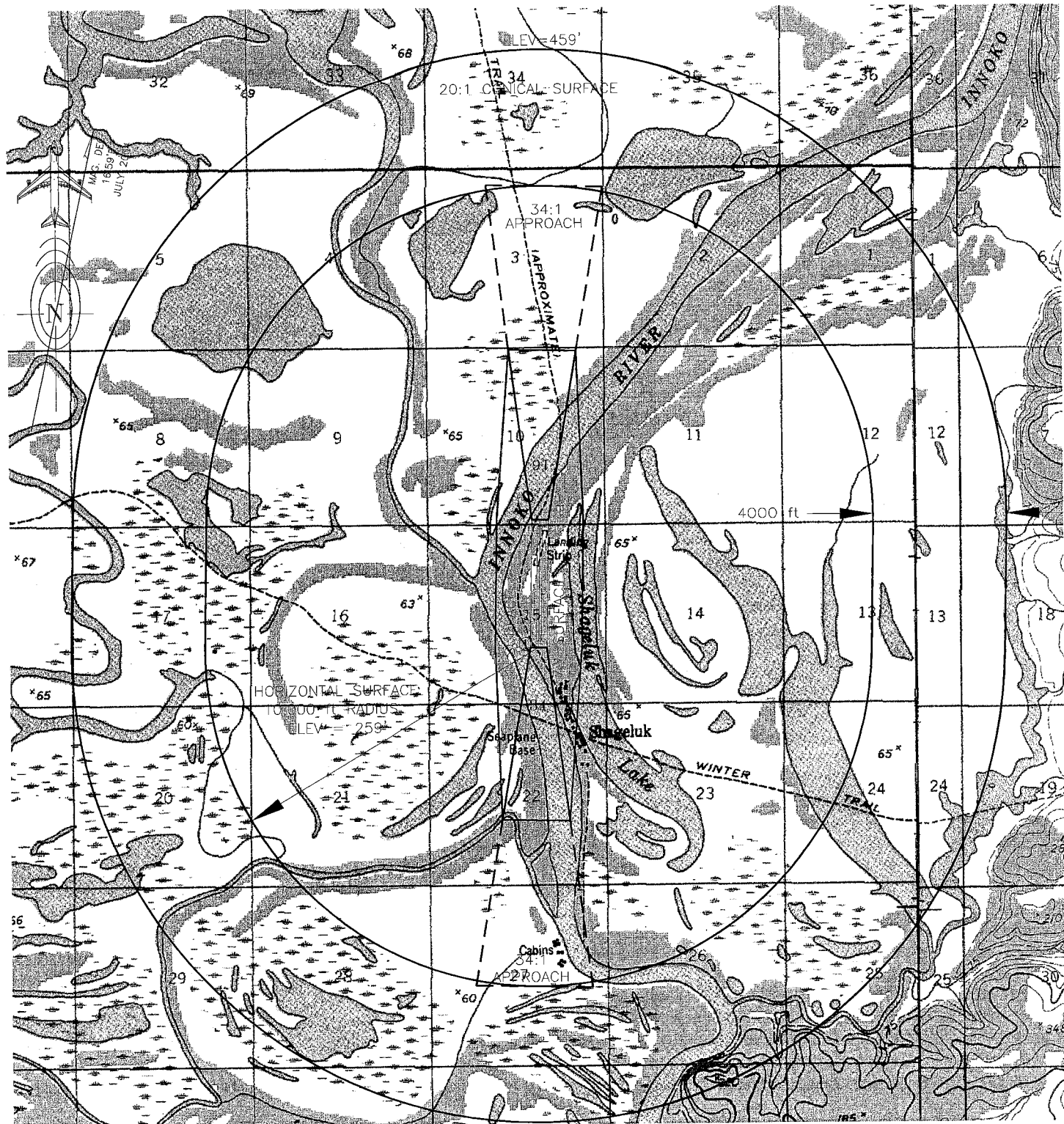

AIRPORT AIRSPACE PLAN

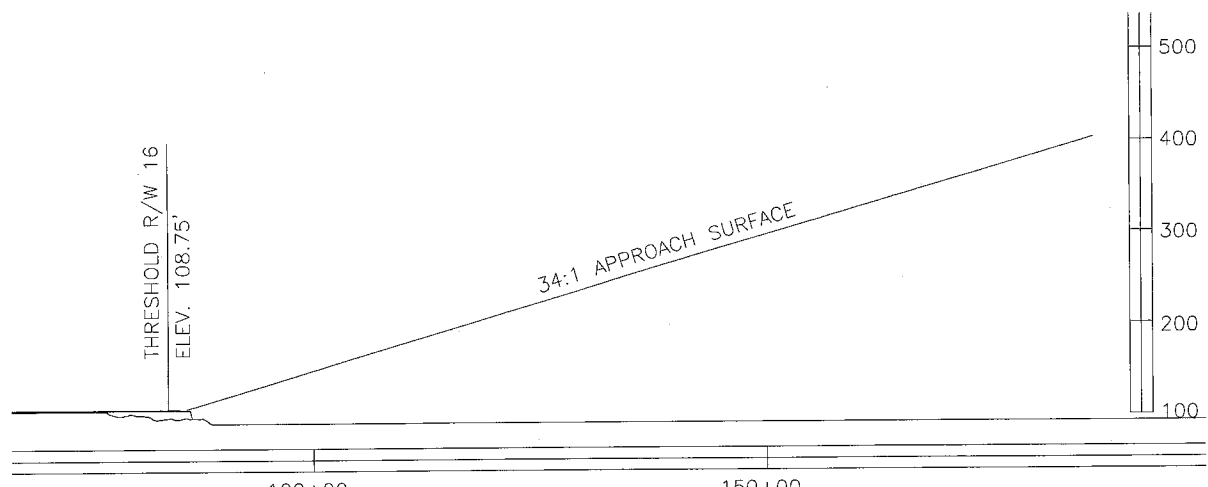

APPROACH PROFILE
RUNWAY 16

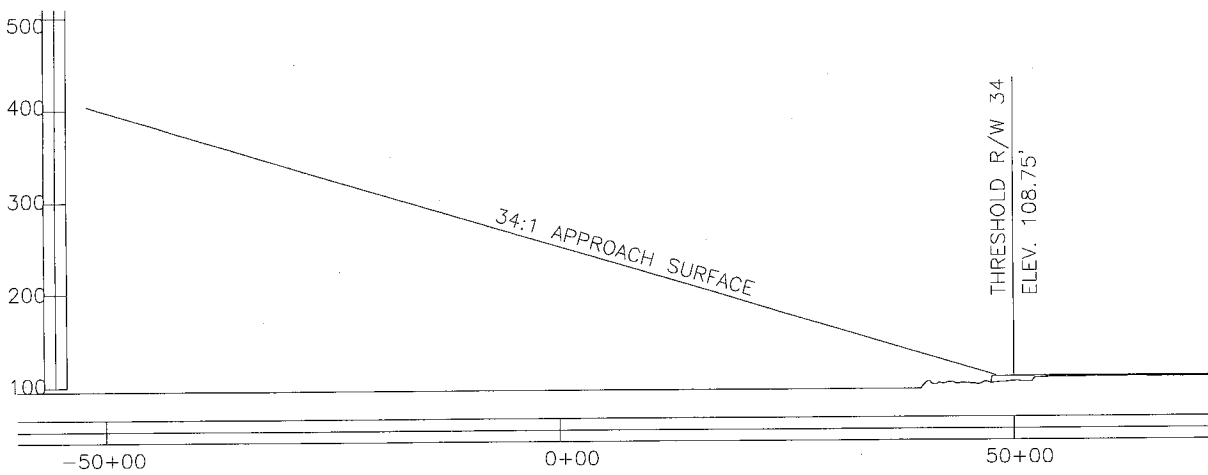

APPROACH PROFILE
RUNWAY 34

DESIGN	OCU		
DRAWN	OCU		
CHECKED	jjj	EM 8/17/04	AS-BUILT
		BY DATE	REVISIONS

STATE OF ALASKA
DEPARTMENT OF TRANSPORTATION AND PUBLIC FACILITIES
NORTHERN REGION-DESIGN AND ENGINEERING SERVICES

APPROVED: *Patricia D. Miller* DATE: 8/18/04
PATRICIA D. MILLER, P.E. DESIGN GROUP CHIEF

AIRPORT LAYOUT PLAN APPROVED
BY LETTER DATED: 8/30/04

J. J. Smith

AIRPORTS DIVISION,
ALASKAN REGION, AAL-601
AIRSPACE REVIEW #99AAL-079NRA

THIS ALP SUPERCEDES THE ALP DATED 2/5/99 AND IS BASED
ON THE AS-BUILT FOR AIP 3-02-0370-02 DATED 11/13/03

SHAGELUK AIRPORT
AIRPORT AIRSPACE DRAWING

SHEET
2 OF 3

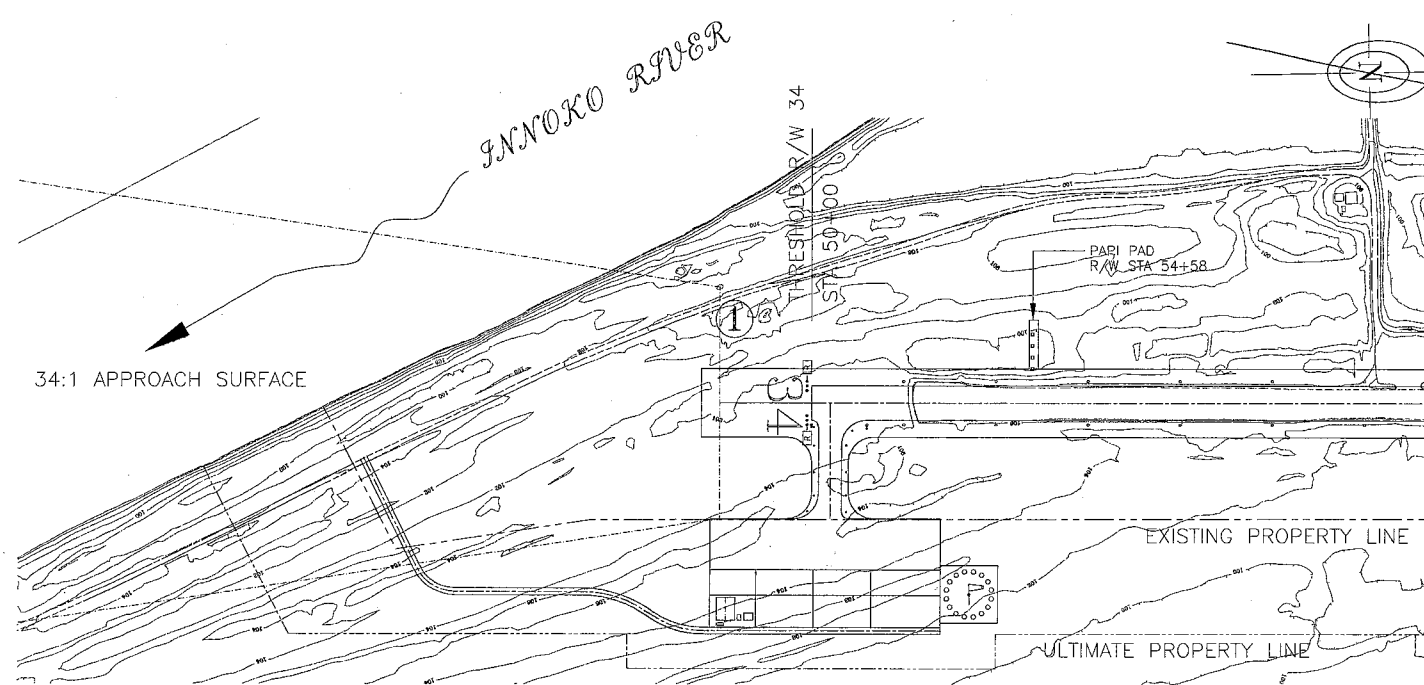

RUNWAY 34 - PLAN

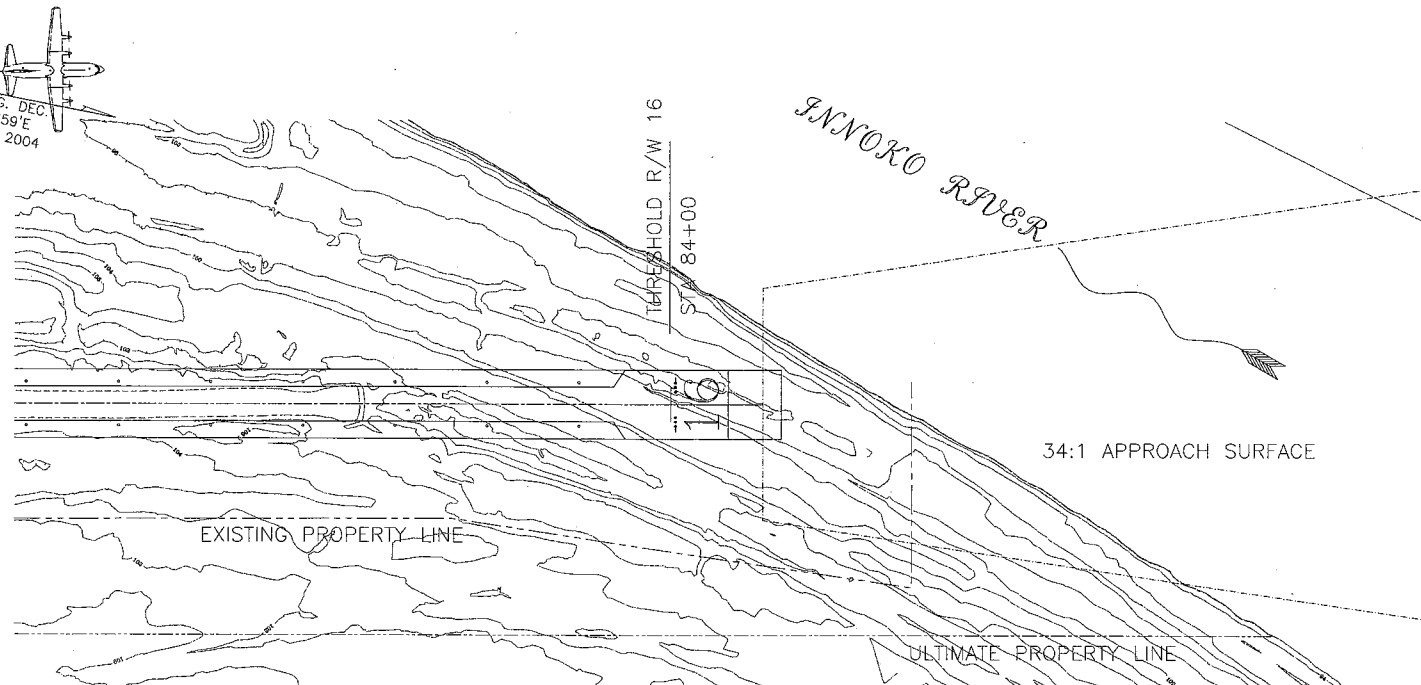

RUNWAY 16 - PLAN

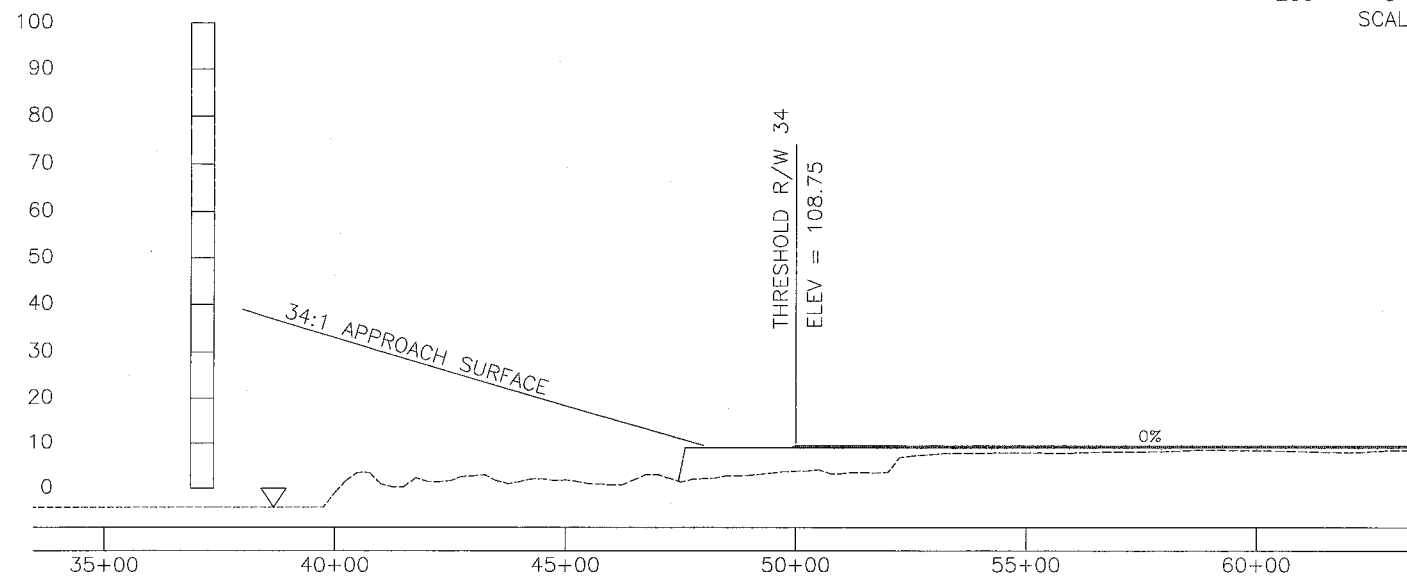
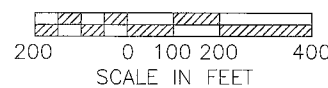

RUNWAY 34 - PROFILE

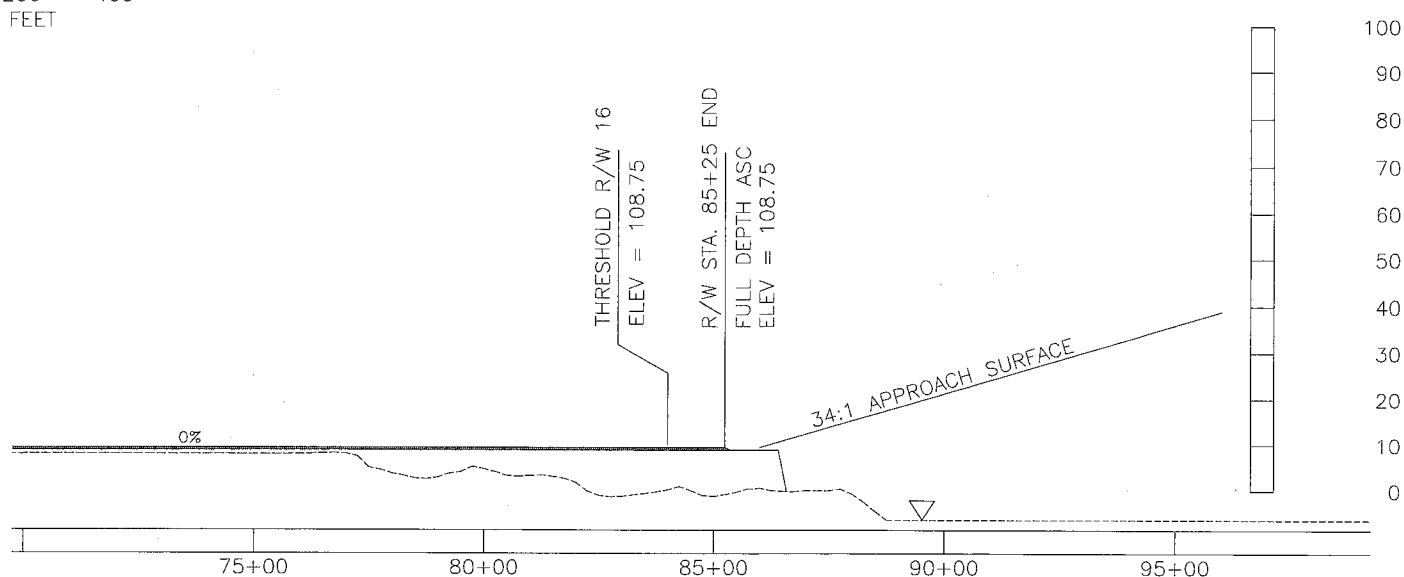

RUNWAY 16 - PROFILE

DESIGN	OCU
DRAWN	OCU
CHECKED	jjc

BY	DATE	REVISIONS
EM	8/17/04	AS-BUILT

STATE OF ALASKA
 DEPARTMENT OF TRANSPORTATION AND PUBLIC FACILITIES
 NORTHERN REGION-DESIGN AND ENGINEERING SERVICES

APPROVED: *Patricia D. Miller*
 PATRICIA D. MILLER, P.E. DATE: 8/28/04
 DESIGN GROUP CHIEF

AIRPORT LAYOUT PLAN APPROVED
 BY LETTER DATED: 8/24/04

J. P. Smith
 AIRPORTS DIVISION,
 ALASKAN REGION, AAL-601
 AIRSPACE REVIEW #99AAL-079NRA

THIS ALP SUPERCEDES THE ALP DATED 2/5/99 AND IS BASED
 ON THE AS-BUILT FOR AIP 3-02-0370-02 DATED 11/13/03

SHAGELUK AIRPORT
 INNER PORTION OF APPROACH SURFACES

SHEET
 3 OF 3