

LOCATION MAP
NO SCALE

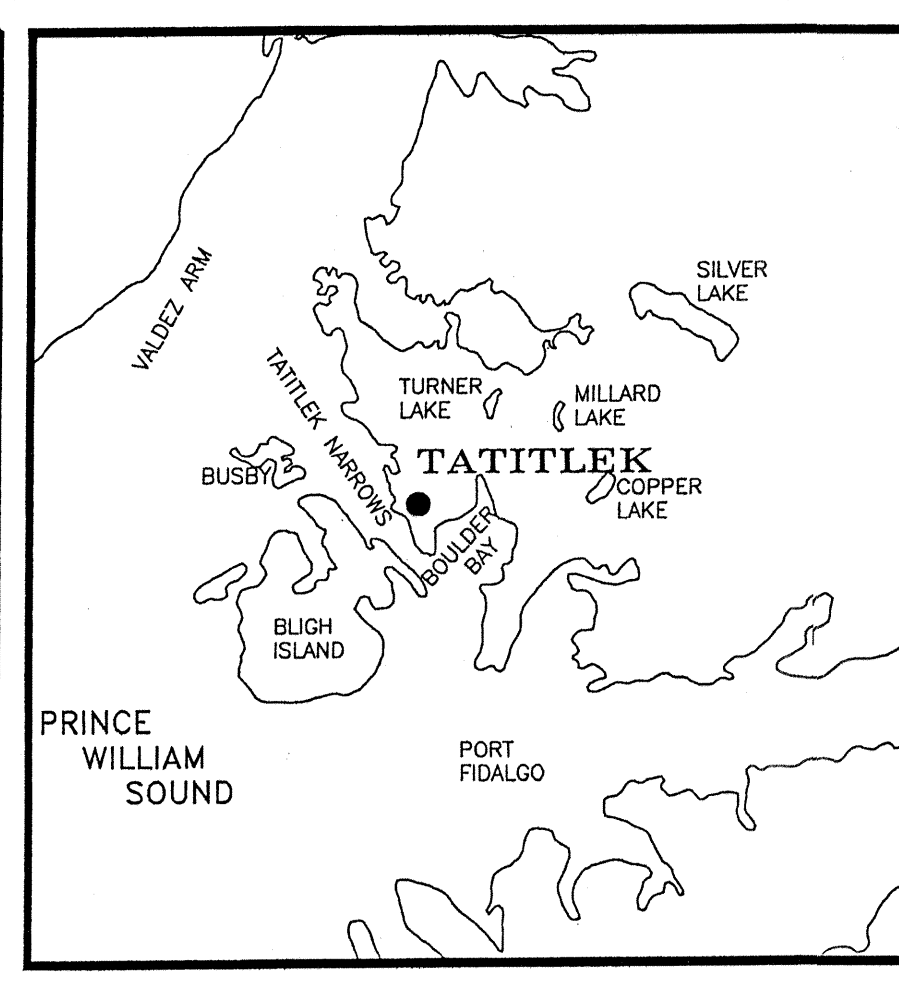

VICINITY MAP

WIND DATA
NO WIND DATA IS AVAILABLE FOR TATITLEK. PILOT REPORTS INDICATE THE EXISTING RUNWAY IS ALIGNED WITH PREVAILING WINDS.

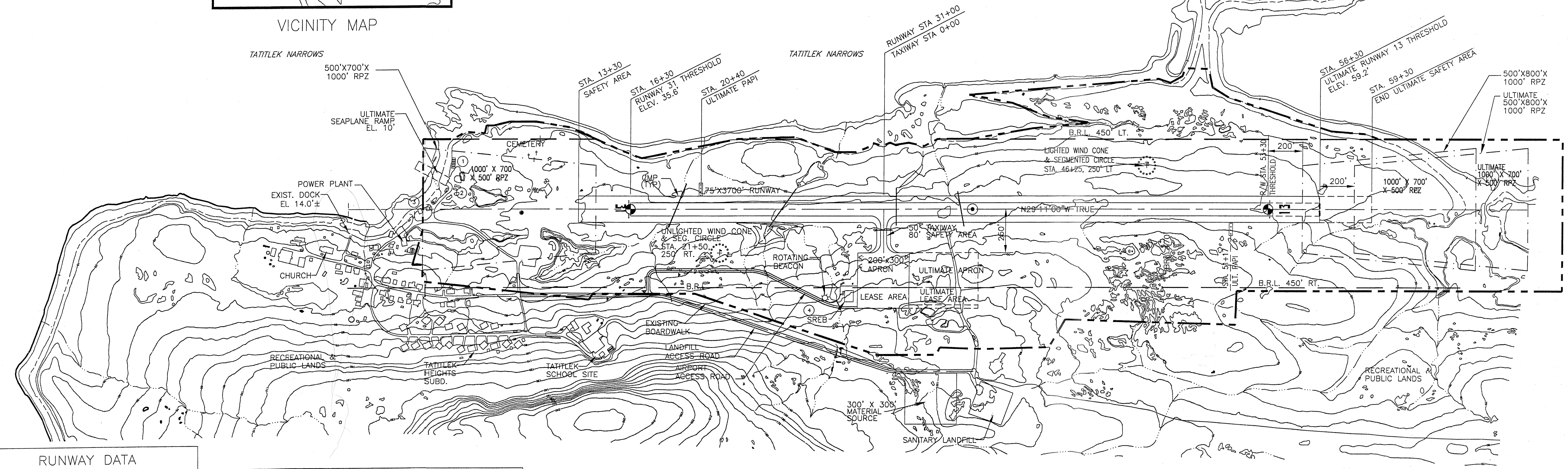
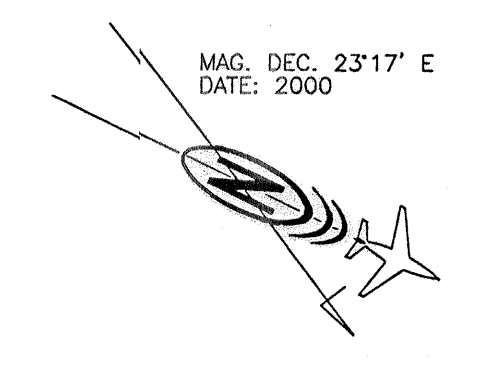

RUNWAY DATA		
	EXISTING	ULTIMATE
% WIND COVERAGE	NO DATA	NO DATA
RUNWAY SURFACE TYPE	GRAVEL	GRAVEL
PAVEMENT STRENGTH	N/A	N/A
APPROACH VISIBILITY MINIMUMS	≥1MILE	≥1MILE
APPROACH SURFACES	20 : 1	20 : 1
RUNWAY LIGHTING	MIRL	MIRL
RUNWAY MARKING	NONE	NONE
VISUAL APPROACH AIDS	NONE	PAPI
R/W DIMENSIONS	3700'X75'	4000'X75'
R/W SAFETY AREA	4300'X150'	4600'X150'
ROFA	4300'X500'	4600'X500'
ROFZ	4100'X400'	4400'X400'
T/W WIDTH	50'	SAME
T/WW SAFETY AREA WIDTH	80'	SAME
TAXIWAY OFA	131'	SAME

AIRPORT DATA			
	EXISTING	ULTIMATE	
AIRPORT ELEVATION (MSL)	57.9'	58.9'	
AIRPORT REFERENCE CODE	B II	B II	
MEAN HIGH TEMP. HOTTEST MONTH (JULY)	60°	60°	
TAXIWAY LIGHTING	MITL	MITL	
RAMP LIGHTING	FLOODLIGHTS	FLOODLIGHTS	
AIRPORT AND TERMINAL NAVAIDS	NONE	NONE	
NAVIGATION AIDS	BEACON	GPS & BEACON	
COMMUNICATION AIDS	NONE	NONE	
AIRPORT REFERENCE POINT (A.R.P.) (NAD 83)	LAT. 60°52'21.95"		LONG. 146°41'29.34"
STA. 36+30	LAT. 60°52'04.76"	SAME	LONG. 146°41'09.64"
THRESHOLD STA. 16+30	LAT. 60°52'04.76"	SAME	LONG. 146°41'09.64"
THRESHOLD STA. 53+30	LAT. 60°52'36.57"	60°52'39.15"	LONG. 146°41'46.08"
EXISTING STA. 53+30	ULTIMATE STA. 56+30		LONG. 146°41'49.04"

DATA BASE CONTROL YEAR: NAD 83

LEGEND		
	EXISTING	ULTIMATE
PROPERTY LINES	---	SAME
BUILDING RESTRICTION LINE (B.R.L.)	B.R.L.	SAME
RUNWAY EMBANKMENT	---	---
WIND CONE & SEGEMENTED CIRCLE	⊙	SAME
BUILDINGS	□	SAME
ROADWAY EMBANKMENT	---	---
THRESHOLD LIGHTS	•••••	•••••
FENCING	x-x-x-x	x-x-x-x
CULVERTS	—	SAME
AIRPORT REFERENCE POINT	⊙	SHORELINE/WATERLINE
ROTATING BEACON	⊙	TREELINE
REBAR WITH AL CAP	⊙	DRAINAGE
PAPI	—	

AIRPORT STRUCTURES			
NO.	ITEM	EXISTING TOP ELEV.	ULTIMATE TOP ELEV.
①	CONEX BLDGS	24.5'	24.5'
②	TRAILERS	22.5'	22.5'
③	SHEDS	24.5'	24.5'
④	SREB	53.9'	53.9'

NONSTANDARD CONDITIONS			
ITEM	EXISTING	STANDARD	ULTIMATE
LANDFILL SETBACK	1,000'	5,000'	1,000'

NOTES
NO OFZ OBJECT PENETRATIONS.
NO THRESHOLD SITING SURFACE OBJECT PENETRATIONS.
THE GEODETIC COORDINATES WERE CALCULATED FROM THE PUBLISHED GEODETIC COORDINATES FOR THE RUNWAY CENTERLINE MONUMENT AT STA. 10+00. SEE PROPERTY PLAN DATED 2/27/95.

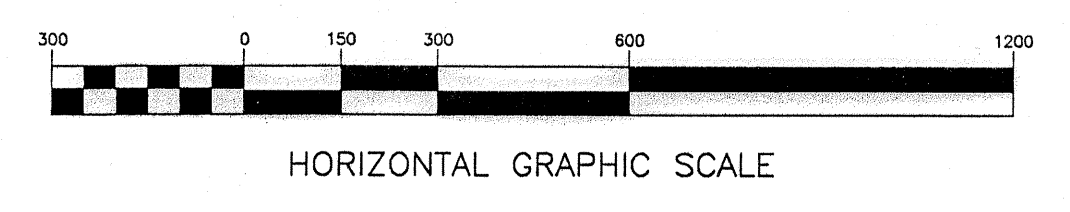

DESIGN_RGS		
DRAWN_CAT		
CHECKED_PDM		
BY	DATE	AS-BUILT
	2/24/99	
		REVISIONS

STATE OF ALASKA
DEPARTMENT OF TRANSPORTATION AND PUBLIC FACILITIES
NORTHERN REGION

APPROVED *Patricia D. Miller* DATE 5/25/00
PATRICIA D. MILLER, P.E. DESIGN GROUP CHIEF

AIRPORT LAYOUT PLAN APPROVED
BY LETTER DATED: 11-27-00
David S. Stelling

AIRPORTS DIVISION,
ALASKAN REGION, AAL-620
Airspace #00AAL-121A1RA

THIS ALP SUPERSEDES APL SIGNED 4/28/95 AND LAST FAA APPROVED 8/7/95.

TATITLEK AIRPORT
AIRPORT LAYOUT PLAN

SHEET
1 OF
3

TRANSITIONAL SURFACES

NO.	OBJECT	R/W STA.	OFFSET	PENE.	DISPOSITION
1	TREES	18+78	262' LT	21.0'	ULTIMATE REMOVAL
2	TREES	19+98	298' LT	17.5'	ULTIMATE REMOVAL
3	TREES	32+02	270' LT	14.4'	ULTIMATE REMOVAL
4	TREES	42+66	345' LT	16.8'	ULTIMATE REMOVAL
5	TREES	46+93	298' LT	1.7'	ULTIMATE REMOVAL
6	TREES	49+81	289' LT	20.8'	ULTIMATE REMOVAL
7	TREES	57+01	324' LT	15.6'	ULTIMATE REMOVAL

TRANSITIONAL SURFACES

NO.	OBJECT	R/W STA.	OFFSET	PENE.	DISPOSITION
8	TREES	53+56	337' RT	9.7'	ULTIMATE REMOVAL
9	SCHOOL	14+34	832' RT	1.7'	ULTIMATE REMOVAL
10	TREES	12+27	460' RT	30'	ULTIMATE REMOVAL
11	HILLSIDE	16+38	646' RT	27'	NONE
12	90' HIGH BEACON	28+76	487' RT	10'	NONE
13	8' WIND CONE	21+50	250' RT	NONE	NONE

SOUTH RPZ

NO.	OBJECT	R/W STA.	OFFSET	PENE.	DISPOSITION
14	TREES	11+78	262' LT	1.4'	NONE
15	CL RD	9+63	291 RT	NONE	NONE

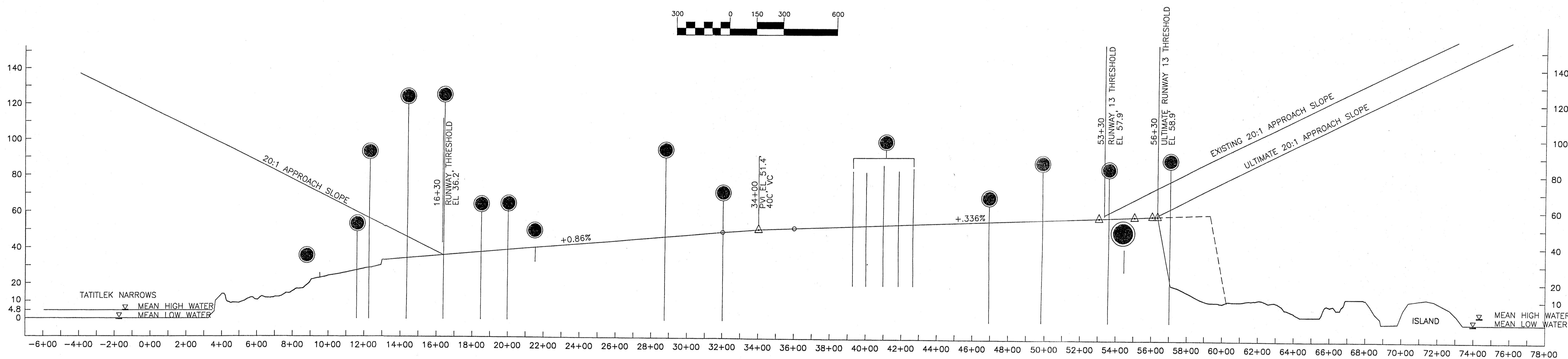
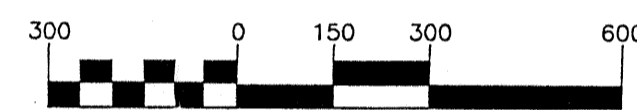
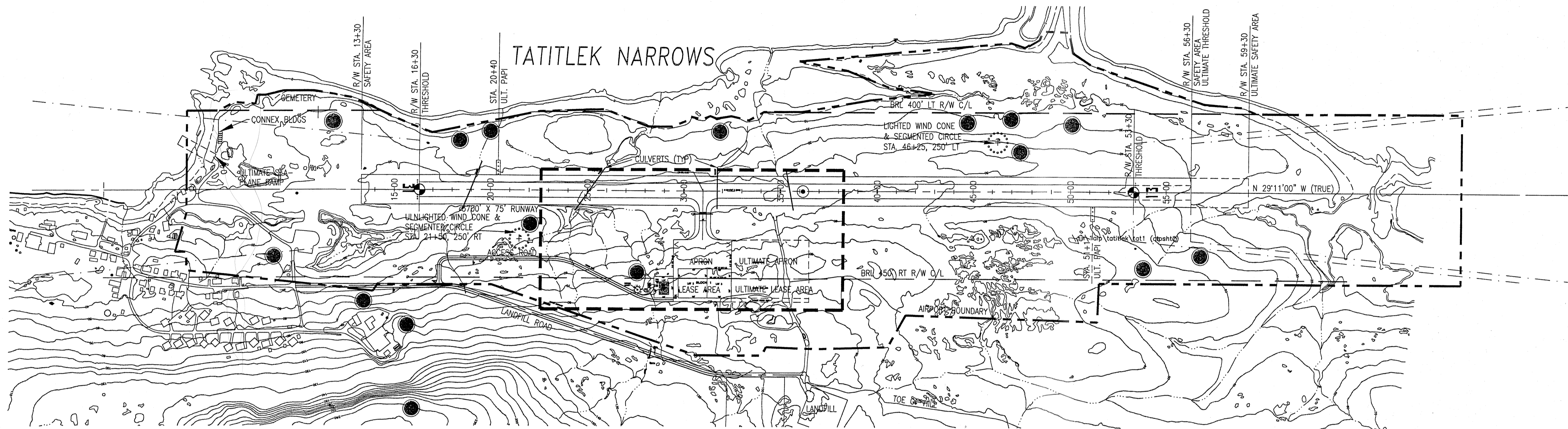
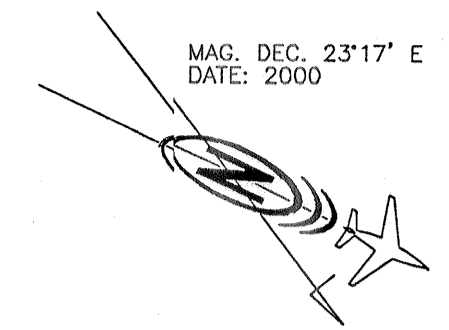

RUNWAY 31-13 PROFILE

DESIGN_RGS	
DRAWN_CAT	
CHECKED_PDM	
CAT	2/24/99 AS-BUILT
BY	DATE REVISIONS

STATE OF ALASKA
 DEPARTMENT OF TRANSPORTATION AND PUBLIC FACILITIES
 NORTHERN REGION

APPROVED *Patricia D. Miller* DATE *5/25/00*
 PATRICIA D. MILLER, P.E. DESIGN GROUP CHIEF

AIRPORT LAYOUT PLAN APPROVED
 BY LETTER DATED: *11-27-00*
David S. Stealing

AIRPORTS DIVISION,
 ALASKAN REGION, AAL-620

TATITLEK AIRPORT
 INNER PORTION OF APPROACH
 SURFACES PLAN & PROFILE

SHEET
 2 OF
 3

MAG. DEC. 23°17' E
DATE: 2000

PRINCE WILLIAM SOUND

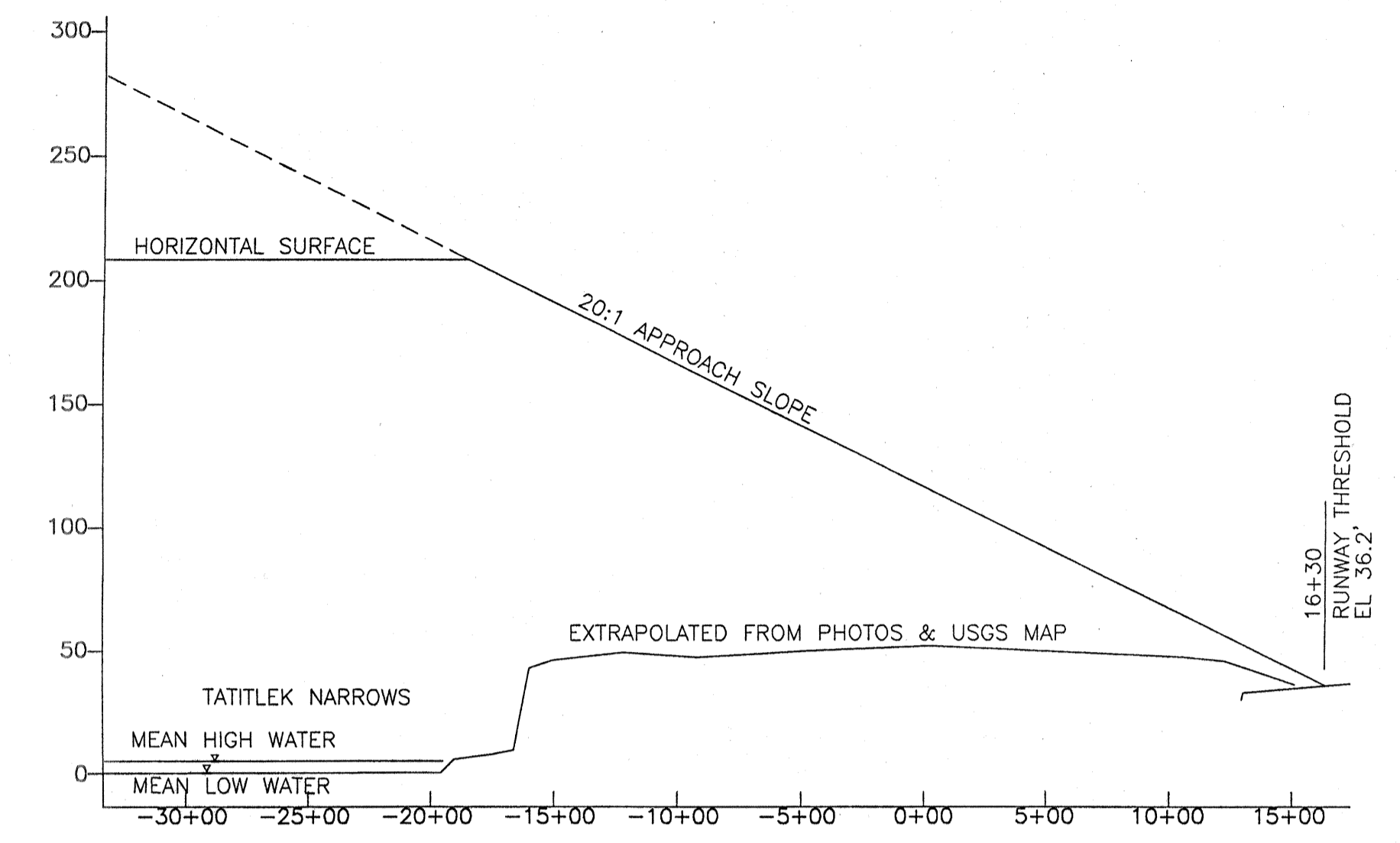
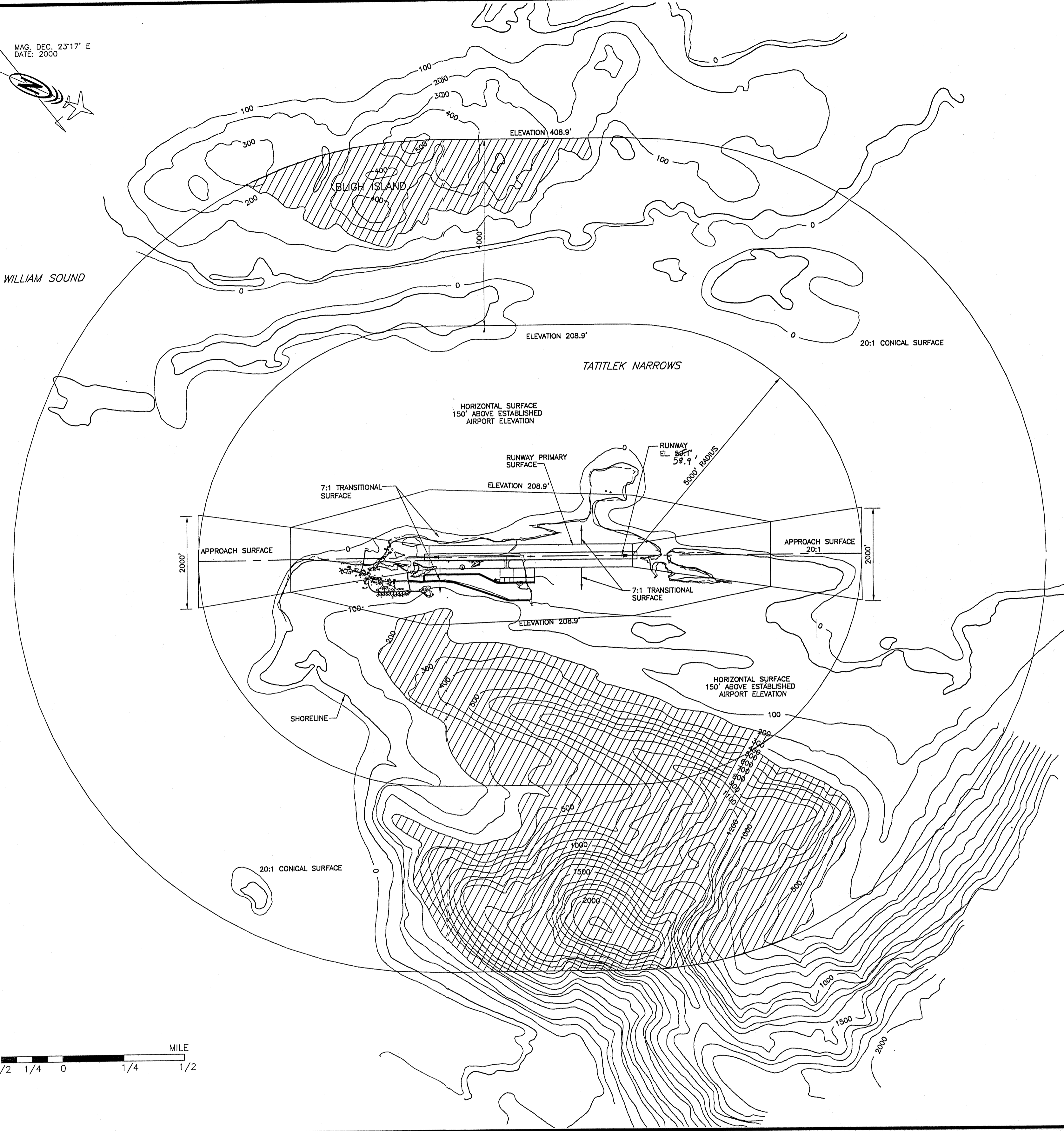

R/W 31 COMPOSITE APPROACH PROFILE

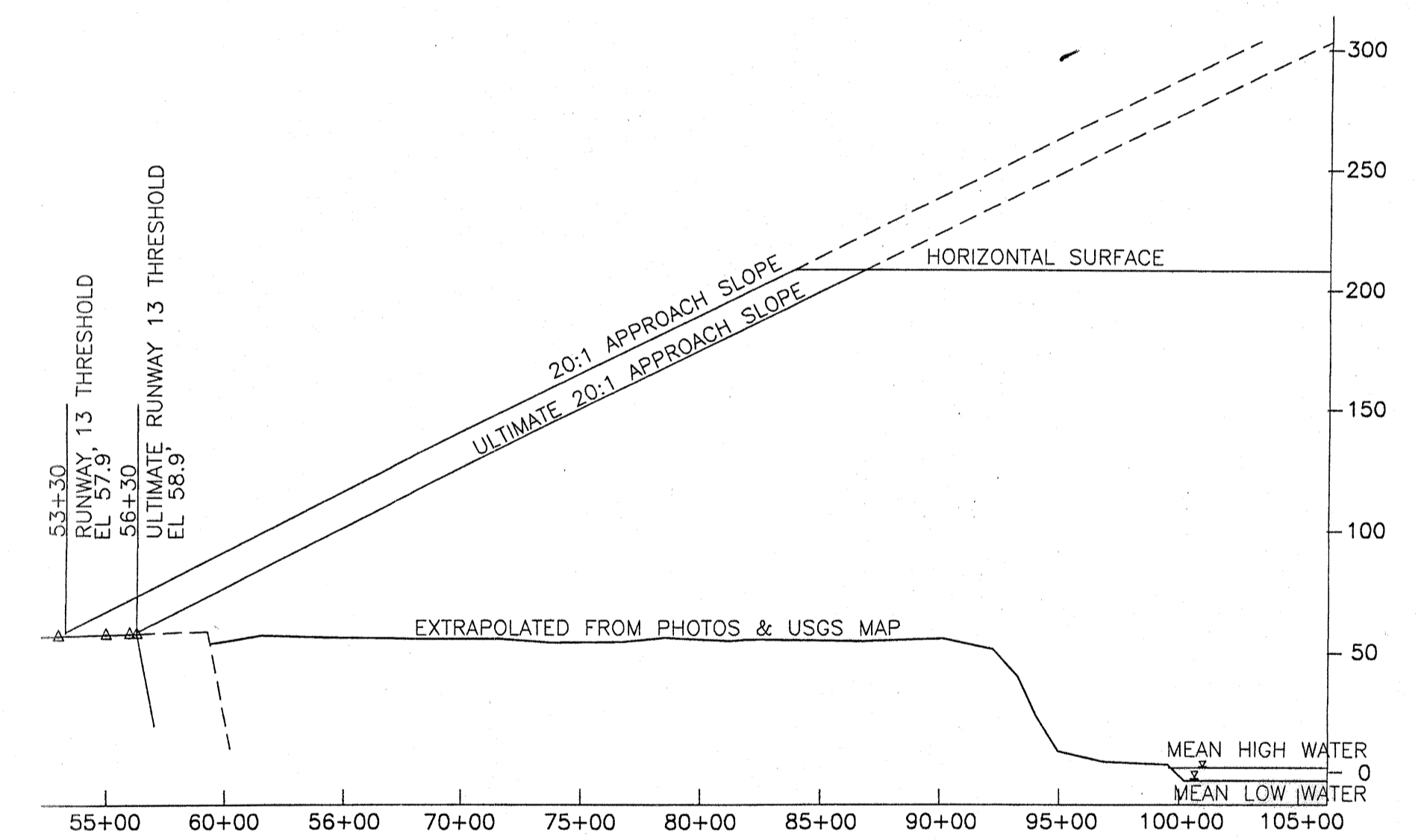

R/W 13 COMPOSITE APPROACH PROFILE

DESIGN_RGS
DRAWN_CAT
CHECKED_PDM

BY	DATE	REVISIONS
CAT	2/24/99	AS-BUILT

STATE OF ALASKA
DEPARTMENT OF TRANSPORTATION AND PUBLIC FACILITIES
NORTHERN REGION

APPROVED *Patricia D. Miller* DATE *5/25/07*
PATRICIA D. MILLER, P.E. DESIGN GROUP CHIEF

AIRPORT LAYOUT PLAN APPROVED
BY LETTER DATED: *11-27-00*
David S. Stelling

AIRPORTS DIVISION,
ALASKAN REGION, AAL-620

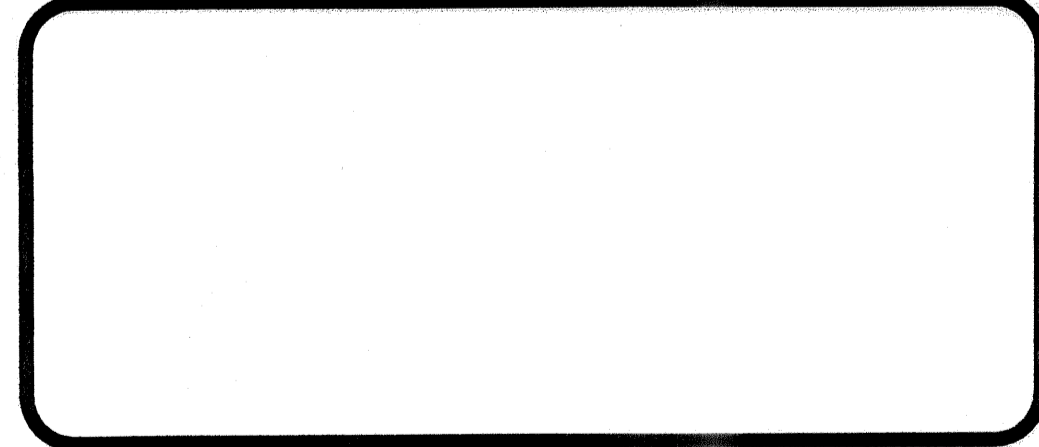

TATITLEK AIRPORT
AIRSPACE AND
COMPOSITE APPROACH PROFILES

SHEET
3 OF 3