

RUNWAY 36 INNER APPROACH PLAN

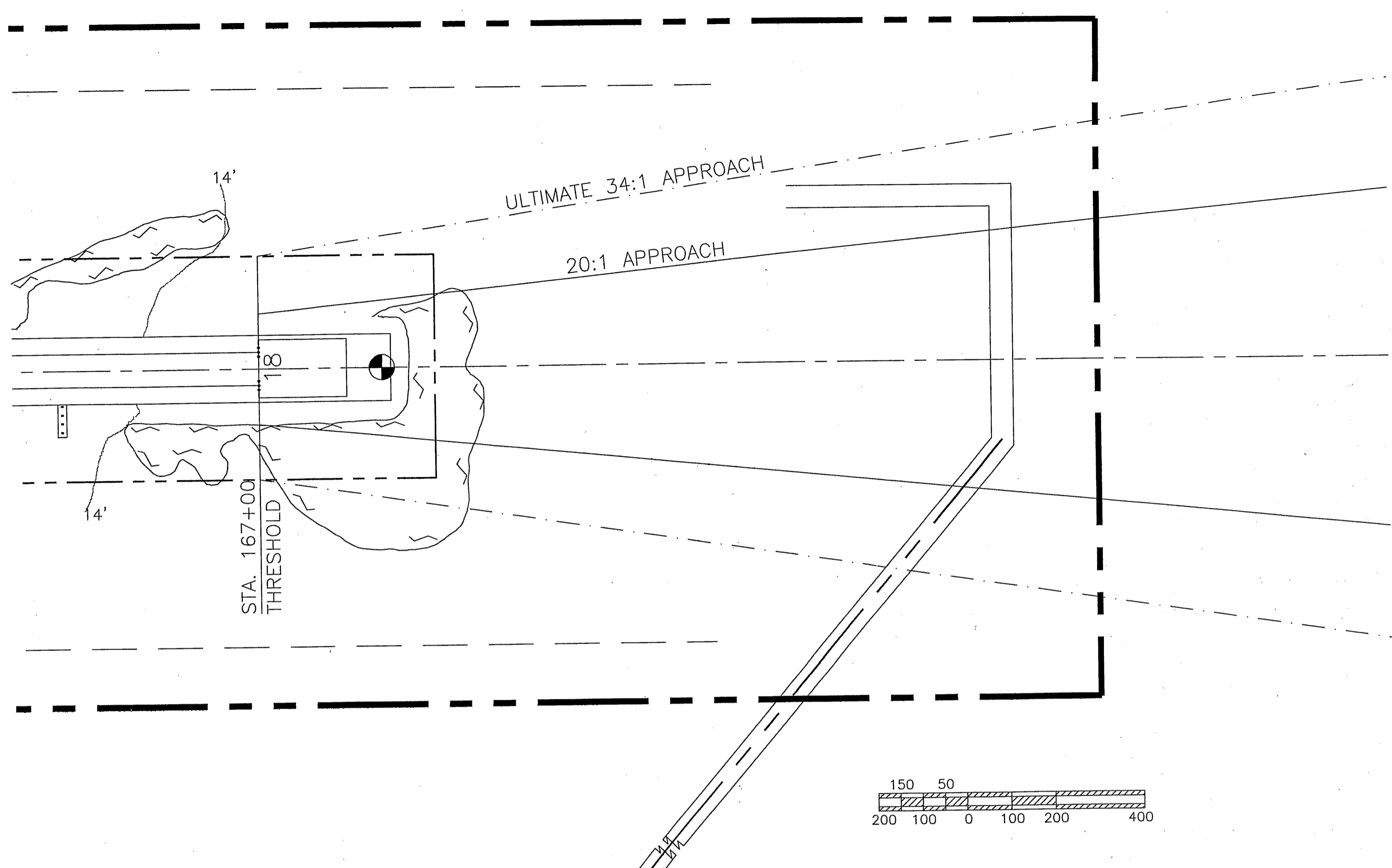

RUNWAY 18 INNER APPROACH PLAN

CLOSE-IN OBSTRUCTONS					
#	OBSTRUCTON	LOCATION	SURFACE PENETRATION	SURFACE	DISPOSITION
1	ROAD	R/W STA. 123+64 300' LT.	5'	34:1 APPROACH	MOVE ROAD TO ULTIMATE LOCATION
2	ROAD	R/W STA. 123+15 307' RT.	3.5'	34:1 APPROACH	MOVE ROAD TO ULTIMATE LOCATION
3	ROAD	R/W STA. 119+25 R/W C/L	NONE	34:1 APPROACH	NO ACTION
4	ROAD	R/W STA. 115+61 421' RT.	NONE	34:1 APPROACH	NO ACTION

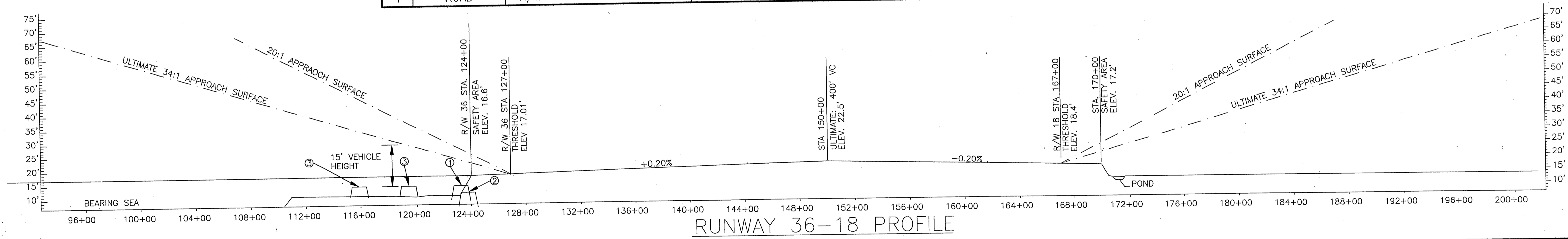

RUNWAY 36-18 PROFILE

DESIGN_CML
DRAWN_CAT/RP
CHECKED_PDM

BY	DATE	REVISIONS
EM	4/24/06	AS-BUILT DATED 1/19/05
	9/25/02	FAA APPROVED

STATE OF ALASKA
DEPARTMENT OF TRANSPORTATION AND PUBLIC FACILITIES
NORTHERN REGION

APPROVED
/s/ *Patricia D. Miller* DATE 4/24/06
PATRICIA D. MILLER, P.E. DESIGN GROUP CHIEF

AIRPORT LAYOUT PLAN APPROVED
BY LETTER DATED: 5/24/06
[Signature]
AIRPORTS DIVISION,
ALASKAN REGION, AAL-601
AIRSPACE REVIEW 06AAL-43NRA

WALES AIRPORT
INNER PORTION OF THE
APPROACH SURFACE PLANS
& PROFILE

SHEET
2 OF 3

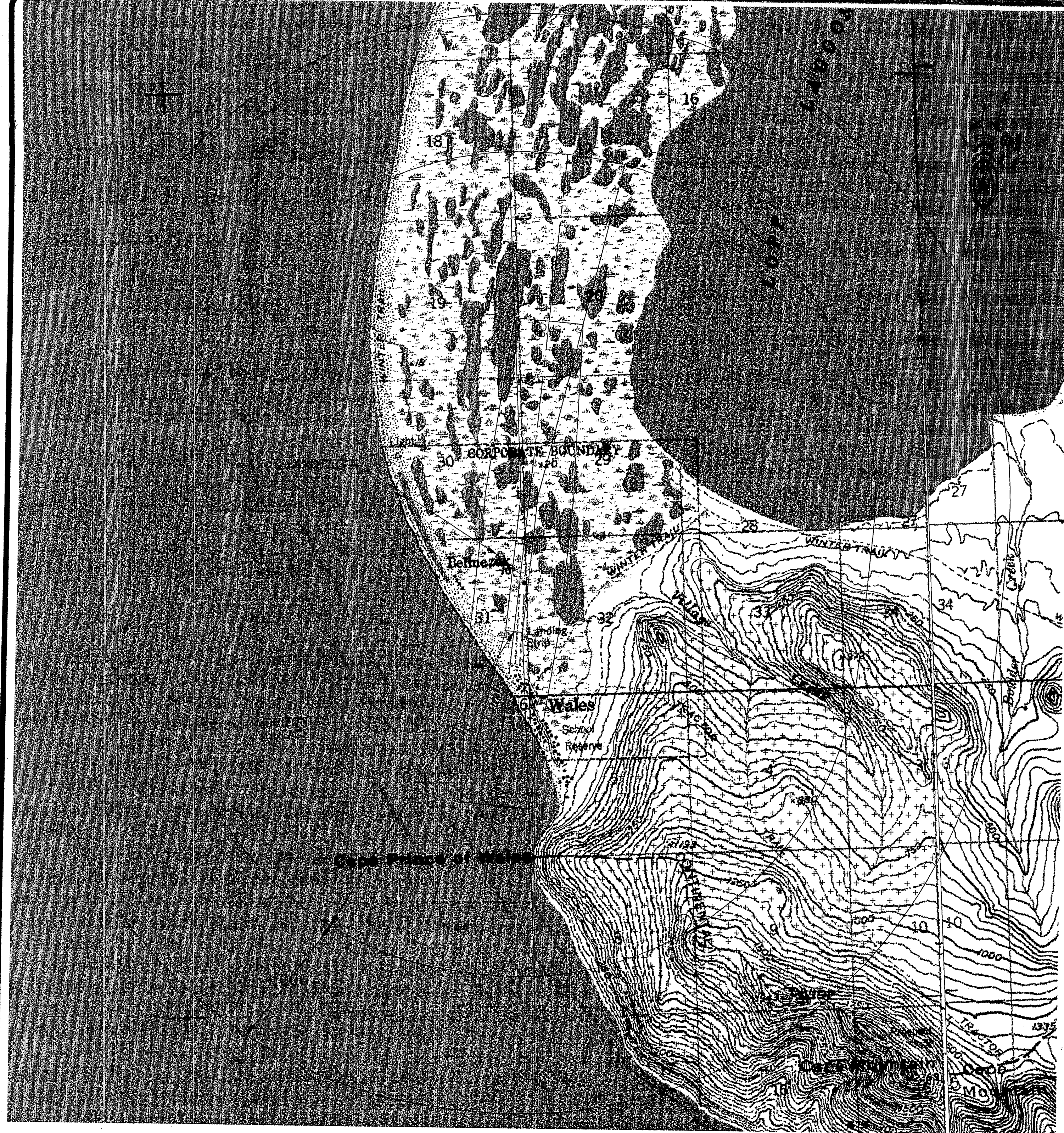

AIRSPACE VICINITY MAP

SCALE 1" = 2000'
 T3N R45W, USGS TELLER (C-7) 1950
 KATEEL RIVER MERIDIAN

LEGEND

- + MOUNTAINS
- + AIR SPACE PENETRATION

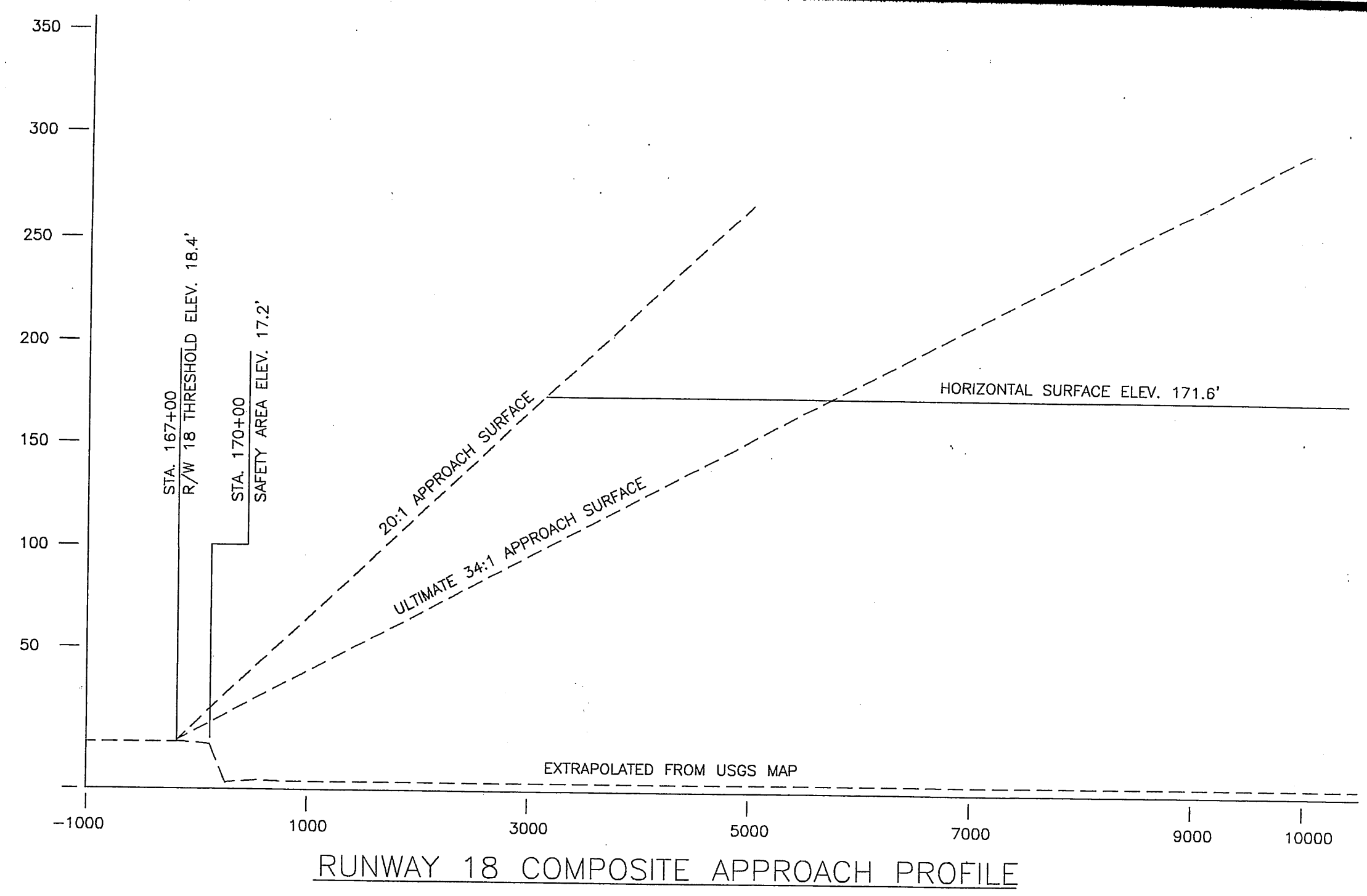

FAR PART 77 OBSTRUCTIONS						
#	OBSTRUCTION	LOCATION	TOP ELEV.	SURFACE PENETRATION	SURFACE	DISPOSITION
1	MOUNTAINS	SE OF R/W 36	1450'	+1278'	HORIZONTAL	NO ACTION
2	MOUNTAINS	SE OF R/W 36	1543'	+1214'	CONICAL	NO ACTION

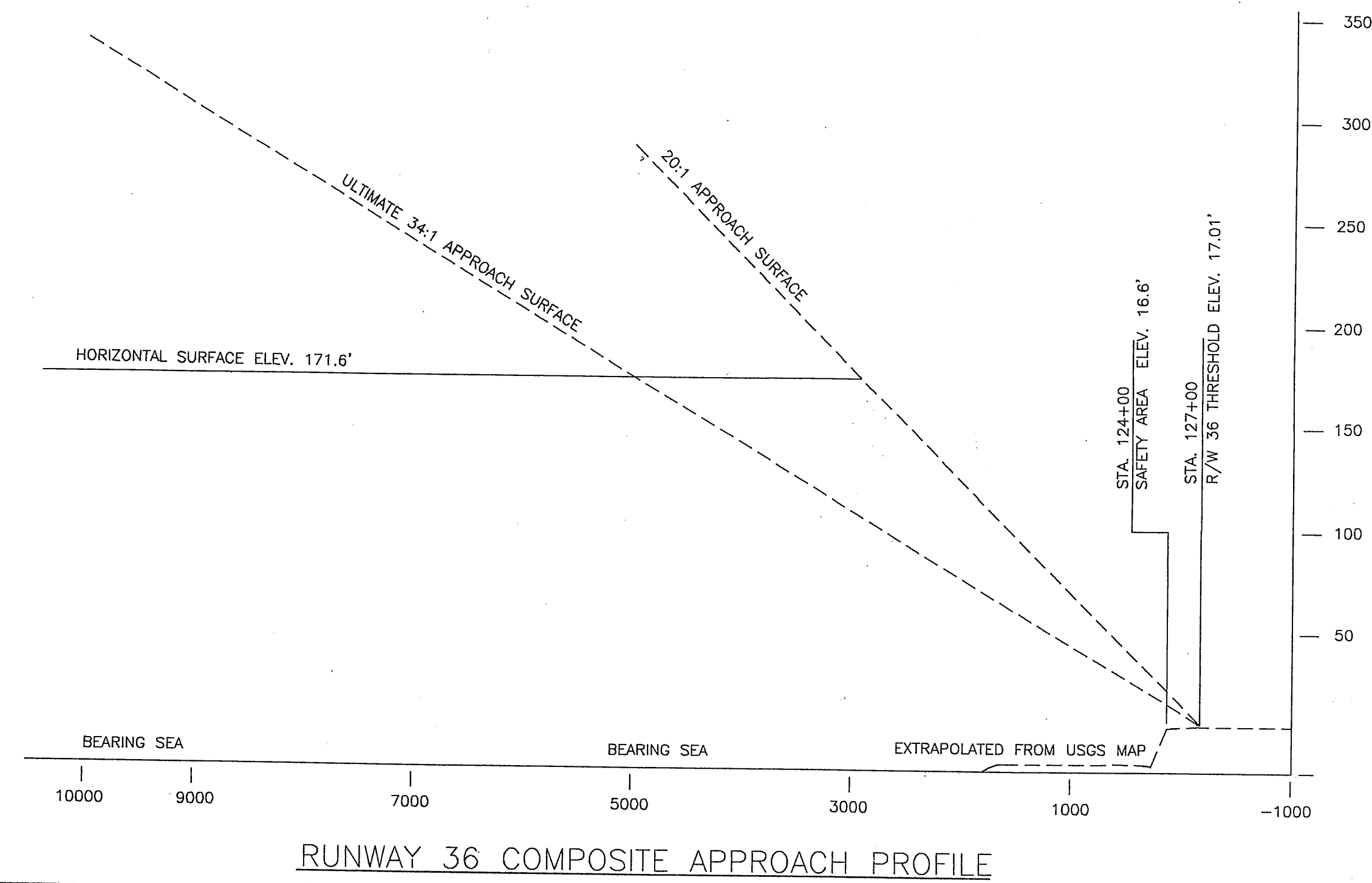

DESIGN_CML

DRAWN_CAT/RP

CHECKED_PDM

EM	DATE	AS-BUILT DATED	REVISIONS
	4/24/06	1/19/05	
	9/25/02	FAA APPROVED	

STATE OF ALASKA
 DEPARTMENT OF TRANSPORTATION AND PUBLIC FACILITIES
 NORTHERN REGION

APPROVED
Patricia D. Miller
 PATRICIA D. MILLER, P.E.

DATE 4/24/06
 DESIGN GROUP CHIEF

AIRPORT LAYOUT PLAN, APPROVED
 BY LETTER DATED: 5/20/05

[Signature]

AIRPORTS DIVISION,
 ALASKAN REGION, AAL-601
 AIRSPACE REVIEW 06AAL-43NRA

WALES AIRPORT
 AIRSPACE & COMPOSITE
 APPROACH PROFILES

SHEET
 3 OF 3

US MAP WALES WALES-AUSHTS